



Alco

Wattmaster
where quality counts



Low Voltage Cable Joining & Heatshrink Catalogue

		Heatshrink	pages 04 - 13
		Overview	04
		Alco Heatshrink	06
		Heatshrink Kits	08
		Heatshrink Straight Through Joint	10
		Heatshrink Repair Sleeve	11
		Alco Lugs and Links	12
		Cast Resin	pages 14 - 21
		Overview	14
		Straight Joint - Type M/MZ	15
		Branch Joint - Type Y	16
		PUR Resin - Type EG	17
		PUR Resin - Type KG	18
		Insulputty and Quickboxes	19
		Junction Boxes	20
		Sealing Kits Selection Chart	21
		Accessories	pages 22 - 31
		Specialty Kit	22
		Tapes	22
		Pressure Kits	26
		High Temperature Glands	26
		Cleaners and Degreasers	27
		Hand Tools	28
		Index	pages 33 - 35
		By Product	33
		By Part Number	34

Selecting the Right Tube for the Joint:

Select your heatshrink depending on the thickness of the cable and the environment that the joint will operate in; for example, thick wall glue lined for maximum protection, medium wall glue lined for medium protection and thin wall glue lined for general protection [see page 6].

Outer Tube:

Select the tube size that will shrink to approximately 1/5 smaller than the outside diameter of the cable. For the overall heatshrink tube, allow a length that is 12 times the outside diameter of the cable, plus the exposed length of the joint.

Inner Tube:

The inner tube size should be 5 times the cable outside diameter, plus the length of the link selected for the joint [see links on page 13]. This length can change depending on the type of joint. There are two types of joints; Symmetrical joint and Staggered joint. The staggered joint has the lowest profile and best insulation. However, it is also the longest joint. The symmetrical joint has the bulkiest profile but the shortest length of joint.

Heatshrink Troubleshooting:

Q: Why doesn't my heatshrink joint look right?

A: There are a couple of reasons why a heatshrink joint may fail and they include; overheating, unequal heating, heating the start/rear of a joint or unprepared cable.

i Overheating:

If you are using a flame torch, ensure that the flame is yellow and that you don't concentrate on one area too much. Make sure you rotate the flame around the cable at all times. You will know whether the heatshrink has been overheated if it turns dusty grey.

ii Unequal Heating:

This is caused by applying more heat to one side than the other. Because the glue in glue lined heatshrink is heat activated, it is designed to melt below the shrinkage point. A moisture path into the joint is created when the glue does not melt evenly.

iii Heating the rear of a joint:

In some circumstances you may be unable to get access to the rear of a joint. The best way to do this is to use a heat deflector which is a curved piece of tin plate [see heating kit on page 9].

iv Unprepared cable:

The cable needs to be clean and abraded. Check the outer cable core is wiped with a rag and methylated spirits, and then slightly heated to dry off any excess moisture to produce a superior bond [see page 27].

Performing the Heatshrink Joint:

Step 1 - Remove the outer sheath of the cable to uncover core wires.

Step 2 - Cut and strip the core wires to suit the copper links.

Step 3 - Cable should be cleaned with a clean rag and methylated spirits etc [see cleaners/degreasers on page 27].

Step 4 - Abrade the insulation on both ends and slide the inner heatshrink sleeves over cores, and the outer heat shrink sleeve over the whole cable [see sanding cloth on page 27].

Step 5 - Make sure all conductors are connected properly and remove any sharp edges.

Step 6 - Insert inner heatshrink over the connectors. Start heatshrinking from the middle and work your way to the ends.

Step 7 - Make sure that you apply equal heat around the whole joint, including front and back.

Step 8 - To create an extra barrier tape both ends of the cable outer joint [see tapes on page 22].

Step 9 - Re-connect any shields or shelling [see earthing accessories on page 26].

Step 10 - Slide the outer heatshrink sleeve over the exposed cores and heat, making sure that equal heat is applied around the whole joint. Make sure you do not overheat.

Step 11 - You will know when to stop shrinking once the tube fits firmly on the cable without folds or creases.

Step 12 - Allow tube to cool down.

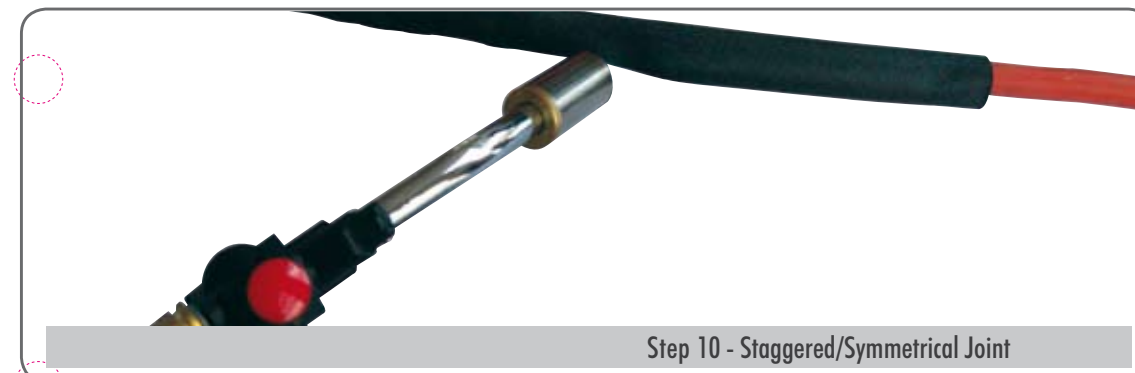
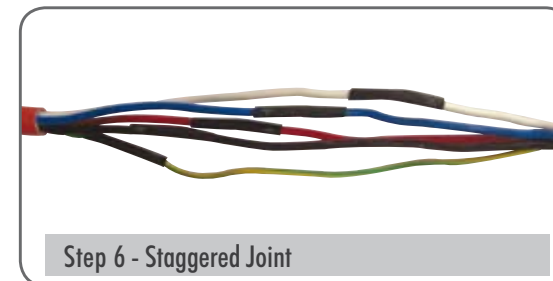
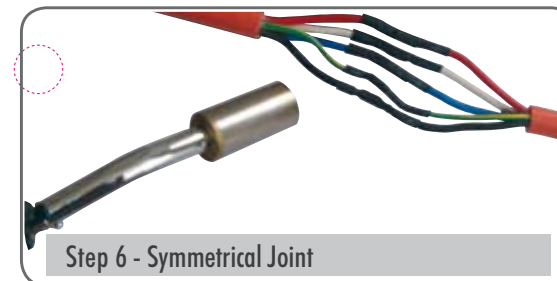
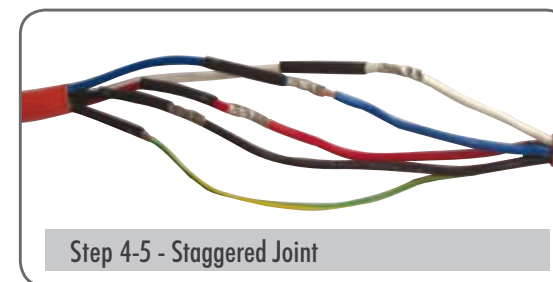
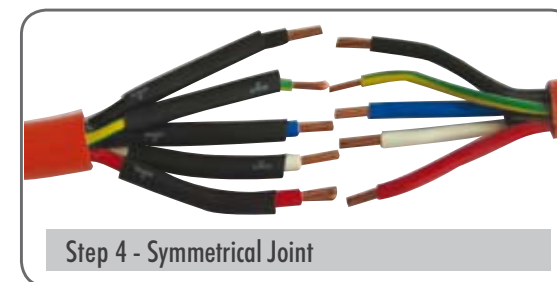
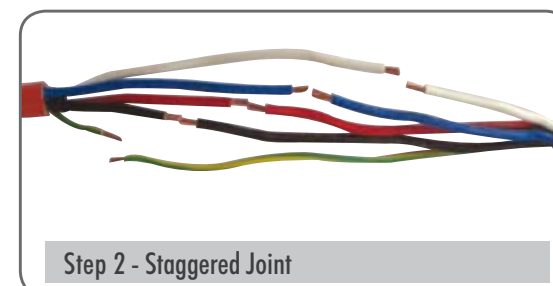
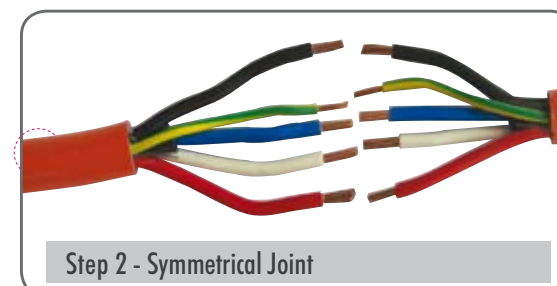

Alco has three heatshrink tubing ranges to choose from depending on the type of application

1 Thin wall range

The Thin Wall range is for general purpose use and is available in a number of colours [blue, black, clear, red, green, yellow & yellow/green] for insulation colour coding and cable terminations.

2 Medium wall range

The Medium Wall range is also for general purpose use, but is glue lined and waterproof. It is available in black only for waterproof cable joints and terminations.

3 Thick wall range

The Thick Wall range is for heavy duty purpose use and, like the medium wall range, is glue lined for greater mechanical strength. This range is available in black only for major cable joints and terminations.

To view Alco's heatshrink tubing ranges please see next page.



Thick Wall



Medium Wall



Thin Wall

Part No	Description	Diameter as supplied (mm)	Fully recovered diameter after heating (mm)	Fully recovered wall thickness (mm)	Length (m)
Thick Wall					
HSTKWGL13/4	Thick Wall Heatshrink, Glue lined, 13/4mm, Black	13.00	4.0	2.00 - 2.80	1.2
HSTKWGL19/6	Thick Wall Heatshrink, Glue lined, 19/6mm, Black	19.00	6.0	2.00 - 2.80	1.2
HSTKWGL28/9	Thick Wall Heatshrink, Glue lined, 28/9mm, Black	28.00	9.0	2.90 - 3.08	1.2
HSTKWGL38/12	Thick Wall Heatshrink, Glue lined, 38/12mm, Black	38.00	12.0	3.97 - 4.16	1.2
HSTKWGL51/16	Thick Wall Heatshrink, Glue lined, 51/16mm, Black	51.00	16.0	3.91 - 4.24	1.2
HSTKWGL68/22	Thick Wall Heatshrink, Glue lined, 68/22mm, Black	68.00	22.0	3.90 - 4.20	1.2
HSTKWGL90/30	Thick Wall Heatshrink, Glue lined, 90/30mm, Black	90.00	30.0	3.92 - 4.21	1.2
HSTKWGL130/36	Thick Wall Heatshrink, Glue lined, 130/36mm, Black	130.00	36.0	4.07 - 4.29	1.2
Medium Wall					
HSMWGL10/3	Medium Wall Heatshrink, Glue lined, 10/3mm, Black	10.00	3.0	0.90 - 1.30	1.2
HSMWGL16/5	Medium Wall Heatshrink, Glue lined, 16/5mm, Black	16.00	5.0	1.40 - 2.00	1.2
HSMWGL25/8	Medium Wall Heatshrink, Glue lined, 25/8mm, Black	25.00	8.0	1.80 - 2.40	1.2
HSMWGL35/12	Medium Wall Heatshrink, Glue lined, 35/12mm, Black	35.00	12.0	1.90 - 2.08	1.2
HSMWGL50/16	Medium Wall Heatshrink, Glue lined, 50/16mm, Black	50.00	16.0	1.94 - 2.10	1.2
HSMWGL85/25	Medium Wall Heatshrink, Glue lined, 85/25mm, Black	85.00	25.0	2.91 - 3.10	1.2
HSMWGL115/34	Medium Wall Heatshrink, Glue lined, 115/34mm, Black	115.00	34.0	3.21 - 3.40	1.2
HSMWGL140/42	Medium Wall Heatshrink, Glue lined, 140/42mm, Black	140.00	42.0	4.51 - 4.61	1.2
Thin Wall					
HSTNW1.5/0.75BK	Thin Wall Heatshrink 1.5/0.75mm Black	2.00	0.75	0.40	1.2
HSTNW1.5/0.75BL	Thin Wall Heatshrink 1.5/0.75mm Blue	2.00	0.75	0.40	1.2
HSTNW1.5/0.75CL	Thin Wall Heatshrink 1.5/0.75mm Clear	2.00	0.75	0.40	1.2
HSTNW1.5/0.75G	Thin Wall Heatshrink 1.5/0.75mm Green	2.00	0.75	0.40	1.2
HSTNW1.5/0.75RD	Thin Wall Heatshrink 1.5/0.75mm Red	2.00	0.75	0.40	1.2
HSTNW1.5/0.75WH	Thin Wall Heatshrink 1.5/0.75mm White	2.00	0.75	0.40	1.2
HSTNW1.5/0.75Y	Thin Wall Heatshrink 1.5/0.75mm Yellow	2.00	0.75	0.40	1.2
HSTNW1.5/0.75YG	Thin Wall Heatshrink 1.5/0.75mm Yellow/Green	2.00	0.75	0.40	1.2
HSTNW2.0/1.0BK	Thin Wall Heatshrink 2.0/1.0mm Black	2.50	1.00	0.40	1.2
HSTNW2.0/1.0BL	Thin Wall Heatshrink 2.0/1.0mm Blue	2.50	1.00	0.40	1.2
HSTNW2.0/1.0CL	Thin Wall Heatshrink 2.0/1.0mm Clear	2.50	1.00	0.40	1.2
HSTNW2.0/1.0RD	Thin Wall Heatshrink 2.0/1.0mm Red	2.50	1.00	0.40	1.2
HSTNW2.0/1.0WH	Thin Wall Heatshrink 2.0/1.0mm White	2.50	1.00	0.40	1.2
HSTNW2.0/1.0Y	Thin Wall Heatshrink 2.0/1.0mm Yellow	2.50	1.00	0.40	1.2
HSTNW2.0/1.0YG	Thin Wall Heatshrink 2.0/1.0mm Yellow/Green	2.50	1.00	0.40	1.2
HSTNW2.5/1.25BK	Thin Wall Heatshrink 2.5/1.25mm Black	3.00	1.20	0.44	1.2
HSTNW2.5/1.25BL	Thin Wall Heatshrink 2.5/1.25mm Blue	3.00	1.20	0.44	1.2
HSTNW2.5/1.25CL	Thin Wall Heatshrink 2.5/1.25mm Clear	3.00	1.20	0.44	1.2
HSTNW2.5/1.25G	Thin Wall Heatshrink 2.5/1.25mm Green	3.00	1.20	0.44	1.2
HSTNW2.5/1.25RD	Thin Wall Heatshrink 2.5/1.25mm Red	3.00	1.20	0.44	1.2
HSTNW2.5/1.25WH	Thin Wall Heatshrink 2.5/1.25mm White	3.00	1.20	0.44	1.2
HSTNW2.5/1.25Y	Thin Wall Heatshrink 2.5/1.25mm Yellow	3.00	1.20	0.44	1.2
HSTNW2.5/1.25YG	Thin Wall Heatshrink 2.5/1.25mm Yellow/Green	3.00	1.20	0.44	1.2
HSTNW5.0/2.5BK	Thin Wall Heatshrink 5.0/2.5mm Black	5.40	2.50	0.56	1.2
HSTNW5.0/2.5BL	Thin Wall Heatshrink 5.0/2.5mm Blue	5.40	2.50	0.56	1.2
HSTNW5.0/2.5CL	Thin Wall Heatshrink 5.0/2.5mm Clear	5.40	2.50	0.56	1.2
HSTNW5.0/2.5G	Thin Wall Heatshrink 5.0/2.5mm Green	5.40	2.50	0.56	1.2
HSTNW5.0/2.5RD	Thin Wall Heatshrink 5.0/2.5mm Red	5.40	2.50	0.56	1.2
HSTNW5.0/2.5WH	Thin Wall Heatshrink 5.0/2.5mm White	5.40	2.50	0.56	1.2
HSTNW5.0/2.5Y	Thin Wall Heatshrink 5.0/2.5mm Yellow	5.40	2.50	0.56	1.2
HSTNW5.0/2.5YG	Thin Wall Heatshrink 5.0/2.5mm Yellow/Green	5.40	2.50	0.56	1.2
HSTNW7.0/3.55BK	Thin Wall Heatshrink 7.0/3.55mm Black	7.40	3.50	0.60	1.2
HSTNW7.0/3.55BL	Thin Wall Heatshrink 7.0/3.55mm Blue	7.40	3.50	0.60	1.2
HSTNW7.0/3.55CL	Thin Wall Heatshrink 7.0/3.55mm Clear	7.40	3.50	0.60	1.2
HSTNW7.0/3.55G	Thin Wall Heatshrink 7.0/3.55mm Green	7.40	3.50	0.60	1.2
HSTNW7.0/3.55RD	Thin Wall Heatshrink 7.0/3.55mm Red	7.40	3.50	0.60	1.2
HSTNW7.0/3.55WH	Thin Wall Heatshrink 7.0/3.55mm White	7.40	3.50	0.60	1.2
HSTNW7.0/3.55Y	Thin Wall Heatshrink 7.0/3.55mm Yellow	7.40	3.50	0.60	1.2
HSTNW7.0/3.55YG	Thin Wall Heatshrink 7.0/3.55mm Yellow/Green	7.40	3.50	0.60	1.2
HSTNW10.0/5.0BK	Thin Wall Heatshrink 10.0/5.0mm Black	10.40	5.00	0.60	1.2
HSTNW10.0/5.0BL	Thin Wall Heatshrink 10.0/5.0mm Blue	10.40	5.00	0.60	1.2
HSTNW10.0/5.0CL	Thin Wall Heatshrink 10.0/5.0mm Clear	10.40	5.00	0.60	1.2
HSTNW10.0/5.0G	Thin Wall Heatshrink 10.0/5.0mm Green	10.40	5.00	0.60	1.2
HSTNW10.0/5.0RD	Thin Wall Heatshrink 10.0/5.0mm Red	10.40	5.00	0.60	1.2
HSTNW10.0/5.0WH	Thin Wall Heatshrink 10.0/5.0mm White	10.40	5.00	0.60	1.2
HSTNW10.0/5.0Y	Thin Wall Heatshrink 10.0/5.0mm Yellow	10.40	5.00	0.60	1.2
HSTNW10.0/5.0YG	Thin Wall Heatshrink 10.0/5.0mm Yellow/Green	10.40	5.00	0.60	1.2
HSTNW13/6.5BK	Thin Wall Heatshrink 13/6.5mm Black	13.40	6.50	0.68	1.2
HSTNW13/6.5BL	Thin Wall Heatshrink 13/6.5mm Blue	13.40	6.50	0.68	1.2
HSTNW13/6.5CL	Thin Wall Heatshrink 13/6.5mm Clear	13.40	6.50	0.68	1.2
HSTNW13/6.5RD	Thin Wall Heatshrink 13/6.5mm Red	13.40	6.50	0.68	1.2
HSTNW13/6.5WH	Thin Wall Heatshrink 13/6.5mm White	13.40	6.50	0.68	1.2

Thin wall heatshrink available in various spool lengths upon request

Part No	Description	Diameter as supplied (mm)	Fully recovered diameter after heating (mm)	Fully recovered wall thickness (mm)	Length (m)
Thin Wall					
HSTNW13/6.5Y	Thin Wall Heatshrink 13/6.5mm Yellow	13.40	6.50	0.68	1.2
HSTNW13/6.5YG	Thin Wall Heatshrink 13/6.5mm Yellow/Green	13.40	6.50	0.68	1.2
HSTNW18/9BK	Thin Wall Heatshrink 18/9mm Black	18.40	9.00	0.76	1.2
HSTNW18/9BL	Thin Wall Heatshrink 18/9mm Blue	18.40	9.00	0.76	1.2
HSTNW18/9CL	Thin Wall Heatshrink 18/9mm Clear	18.40	9.00	0.76	1.2
HSTNW18/9G	Thin Wall Heatshrink 18/9mm Green	18.40	9.00	0.76	1.2
HSTNW18/9RD	Thin Wall Heatshrink 18/9mm Red	18.40	9.00	0.76	1.2
HSTNW18/9WH	Thin Wall Heatshrink 18/9mm White	18.40	9.00	0.76	1.2
HSTNW18/9Y	Thin Wall Heatshrink 18/9mm Yellow	18.40	9.00	0.76	1.2
HSTNW18/9YG	Thin Wall Heatshrink 18/9mm Yellow/Green	18.40	9.00	0.76	1.2
HSTNW22/11BK	Thin Wall Heatshrink 22/11mm Black	22.50	11.00	0.78	1.2
HSTNW22/11BL	Thin Wall Heatshrink 22/11mm Blue	22.50	11.00	0.78	1.2
HSTNW22/11CL	Thin Wall Heatshrink 22/11mm Clear	22.50	11.00	0.78	1.2
HSTNW22/11G	Thin Wall Heatshrink 22/11mm Green	22.50	11.00	0.78	1.2
HSTNW22/11RD	Thin Wall Heatshrink 22/11mm Red	22.50	11.00	0.78	1.2
HSTNW22/11WH	Thin Wall Heatshrink 22/11mm White	22.50	11.00	0.78	1.2
HSTNW22/11Y	Thin Wall Heatshrink 22/11mm Yellow	22.50	11.00	0.78	1.2
HSTNW22/11YG	Thin Wall Heatshrink 22/11mm Yellow/Green	22.50	11.00	0.78	1.2
HSTNW40/20BK	Thin Wall Heatshrink 40/20mm Black	40.50	20.00	0.98	1.2
HSTNW40/20BL	Thin Wall Heatshrink 40/20mm Blue	40.50	20.00	0.98	1.2
HSTNW40/20CL	Thin Wall Heatshrink 40/20mm Clear	40.50	20.00	0.98	1.2
HSTNW40/20G	Thin Wall Heatshrink 40/20mm Green	40.50	20.00	0.98	1.2
HSTNW40/20RD	Thin Wall Heatshrink 40/20mm Red	40.50	20.00	0.98	1.2
HSTNW40/20WH	Thin Wall Heatshrink 40/20mm White	40.50	20.00	0.98	1.2
HSTNW40/20Y	Thin Wall Heatshrink 40/20mm Yellow	40.50	20.00	0.98	1.2
HSTNW40/20YG	Thin Wall Heatshrink 40/20mm Yellow/Green	40.50	20.00	0.98	1.2
HSTNW50/25BK	Thin Wall Heatshrink 50/25mm Black	50.50	25.00	0.98	1.2
HSTNW50/25BL	Thin Wall Heatshrink 50/25mm Blue	50.50	25.00	0.98	1.2
HSTNW50/25CL	Thin Wall Heatshrink 50/25mm Clear	50.50	25.00	0.98	1.2
HSTNW50/25G	Thin Wall Heatshrink 50/25mm Green	50.50	25.00	0.98	1.2
HSTNW50/25RD	Thin Wall Heatshrink 50/25mm Red	50.50	25.00	0.98	1.2
HSTNW50/25WH	Thin Wall Heatshrink 50/25mm White	50.50	25.00	0.98	1.2
HSTNW50/25Y	Thin Wall Heatshrink 50/25mm Yellow	50.50	25.00	0.98	1.2
HSTNW50/25YG	Thin Wall Heatshrink 50/25mm Yellow/Green	50.50	25.00	0.98	1.2
HSTNW70/35BK	Thin Wall Heatshrink 70/35mm Black	70.50	35.00	1.10	1.2
HSTNW70/35BL	Thin Wall Heatshrink 70/35mm Blue	70.50	35.00	1.10	1.2
HSTNW70/35CL	Thin Wall Heatshrink 70/35mm Clear	70.50	35.00	1.10	1.2
HSTNW70/35G	Thin Wall Heatshrink 70/35mm Green	70.50	35.00	1.10	1.2
HSTNW70/35RD	Thin Wall Heatshrink 70/35mm Red	70.50	35.00	1.10	1.2
HSTNW70/35WH	Thin Wall Heatshrink 70/35mm White	70.50	35.00	1.10	1.2
HSTNW70/35Y	Thin Wall Heatshrink 70/35mm Yellow	70.50	35.00	1.10	1.2
HSTNW70/35YG	Thin Wall Heatshrink 70/35mm Yellow/Green	70.50	35.00	1.10	1.2
HSTNW100/50BK	Thin Wall Heatshrink 100/50mm Black	100.00	50.00	1.20	1.2
HSTNW100/50BL	Thin Wall Heatshrink 100/50mm Blue	100.00	50.00	1.20	1.2
HSTNW100/50CL	Thin Wall Heatshrink 100/50mm Clear	100.00	50.00	1.20	1.2
HSTNW100/50G	Thin Wall Heatshrink 100/50mm Green	100.00	50.00	1.20	1.2
HSTNW100/50RD	Thin Wall Heatshrink 100/50mm Red	100.00	50.00	1.20	1.2
HSTNW100/50WH	Thin Wall Heatshrink 100/50mm White	100.00	50.00	1.20	1.2
HSTNW100/50Y	Thin Wall Heatshrink 100/50mm Yellow	100.00	50.00	1.20	1.2
HSTNW100/50YG	Thin Wall Heatshrink 100/50mm Yellow/Green	100.00	50.00	1.20	1.2
HSTNW120/60BK	Thin Wall Heatshrink 120/60mm Black	120.00	60.00	1.30	1.2
HSTNW120/60BL	Thin Wall Heatshrink 120/60mm Blue	120.00	60.00	1.30	1.2
HSTNW120/60CL	Thin Wall Heatshrink 120/60mm Clear	120.00	60.00	1.30	1.2
HSTNW120/60RD	Thin Wall Heatshrink 120/60mm Red	120.00	60.00	1.30	1.2
HSTNW120/60WH	Thin Wall Heatshrink 120/60mm White	120.00	60.00	1.30	1.2
HSTNW120/60Y	Thin Wall Heatshrink 120/60mm Yellow	120.00	60.00	1.30	1.2
HSTNW120/60YG	Thin Wall Heatshrink 120/60mm Yellow/Green	120.00	60.00	1.30	1.2
HSTNW150/75BK	Thin Wall Heatshrink 150/75mm Black	149.00	74.50	1.90	1.2
HSTNW150/75BL	Thin Wall Heatshrink 150/75mm Blue	149.00	74.50	1.90	1.2
HSTNW150/75CL	Thin Wall Heatshrink 150/75mm Clear	149.00	74.50	1.90	1.2
HSTNW150/75RD	Thin Wall Heatshrink 150/75mm Red	149.00	74.50	1.90	1.2
HSTNW150/75WH	Thin Wall Heatshrink 150/75mm White	149.00	74.50	1.90	1.2
HSTNW150/75Y	Thin Wall Heatshrink 150/75mm Yellow	149.00	74.50	1.90	1.2
HSTNW150/75YG	Thin Wall Heatshrink 150/75mm Yellow/Green	149.00	74.50	1.90	1.2
HSTNW200/75BK	Thin Wall Heatshrink 200/75mm Black	199.00	75.00	1.90	1.2
HSTNW200/75BL	Thin Wall Heatshrink 200/75mm Blue	199.00	75.00	1.90	1.2
HSTNW200/75CL	Thin Wall Heatshrink 200/75mm Clear	199.00	75.00	1.90	1.2
HSTNW200/75RD	Thin Wall Heatshrink 200/75mm Red	199.00	75.00	1.90	1.2
HSTNW200/75WH	Thin Wall Heatshrink 200/75mm White	199.00	75.00	1.90	1.2
HSTNW200/75Y	Thin Wall Heatshrink 200/75mm Yellow	199.00	75.00	1.90	1.2
HSTNW200/75YG	Thin Wall Heatshrink 200/75mm Yellow/Green	199.00	75.00	1.90	1.2

Thin wall heatshrink available in various spool lengths upon request



Heatshrink Tube - Thin, Medium and Thick Wall Range

Purpose:
Heatshrink is ideally used for electrical insulation, termination, splicing, bundling, cable protection and strain relief

Specifications:
Low Shrink Temperature, Flame Retardant, Flexible and UV Resistant

Shrink Temperature:
Above 110 °C

Shrink Ratio:
Radial Shrinking Ratio:
> 50%

Longitudinal Shrinking Ratio:
< 10%

Operating Temperature:
-55 °C to +125 °C

Standard Colours:
Medium and Thick Wall range available in black colour only

Thin Wall range available in Blue, Clear, Green, White, Red, Black, Yellow and Yellow/Green

Listed in the table below are the technical specifications for Alco thin, medium and thick wall heatshrink ranges.

Specifications			
Property	Test Method	Index	Performance
Physical			
Tensile Strength (MPa)	UL224	not less than 12.0MPa	15.5
Elongation at break (%)	UL224	not less than 450%	580
Heat aging performance	UL224		PASS
Electron			
High Voltage (kV/mm)	UL224	not less than 2.5kV	28
Volume Resistivity (Ω cm)	ASTMD257	not less than 2x10 ¹⁴ ohm/cm	2.8 x 10 ¹⁴
Chemical			
Dielectric constant	ASTMD150	not more than 3.5	Pass
Flame Stability	UL V w-1	Pass	Pass
Breakdown Voltage		not less than 20kV/mm	
Water Absorption		not more than 0.2%	

General Purpose Heatshrink Kit		ALCHSKIT 1
Contents		
Part No.	Description	
HSTNW2.5/1.25	55mm lengths available in a variety of colours	
HSTNW5.0/2.5	55mm lengths available in a variety of colours	
HSTNW7.0/3.55	55mm lengths available in a variety of colours	
HSTNW10.0/5.0	55mm lengths available in a variety of colours	
HSTNW13/6.5	55mm lengths available in a variety of colours	
HSTNW18/9	250mm lengths available in a variety of colours	
HSTNW22/11	250mm lengths available in a variety of colours	



ALCHSKIT 1

Multi Purpose Heatshrink Kit		ALCHSKIT 2
Contents		
Part No.	Description	
HSTNW2.5/1.25	55mm lengths available in a variety of colours	
HSTNW5.0/2.5	55mm lengths available in a variety of colours	
HSTNW7.0/3.55	55mm lengths available in a variety of colours	
HSTNW10.0/5.0	55mm lengths available in a variety of colours	
HSTNW13/6.5	55mm lengths available in a variety of colours	
HSTNW18/9	55mm lengths available in a variety of colours	
HSTNW22/11	55mm lengths available in a variety of colours	
HSMWGL10/3	250mm lengths available in black only	
HSMWGLW25/8	250mm lengths available in black only	



ALCHSKIT 2



Alco has an extensive range of electrical connectors for joining electrical circuits together. Our range consists of pre-insulated terminals, lugs and links, tooling and special kits.

To view our complete range please see our Pre-insulated Terminals, Lugs and Links Catalogue for more information.

For a FREE copy of our catalogue please call our service centre on 1300 300 747

Features		
• 2000W powered heat gun	• 6 piece accessory set included	
• 2 heat settings: 300 °C & 500 °C	• 230V, 50Hz input power	
• Ceramic element	• 4 nozzles	
• Rocket switch type	• Hanging ring	
• Handsfree standing base	• 12 month warranty	
• Convenient protective carry case for storing heat gun included		
Specifications		
Part No.	Description	Weight
WATHGK	7pc Heat Gun Kit	1720g



WATHGK

Copper Lugs and Links Kit			ALCLLKIT 10		
Part No.	Description	Conductor Size	Stud Size	Colour	QTY
WATMH4NW	Ratchet Crimper	-	-	-	1
ALCLK1.5	Crimp Link	1.5mm ²	-	Copper	100
ALCLK2.5	Crimp Link	2.5mm ²	-	Copper	100
ALCLK6	Crimp Link	6.0mm ²	-	Copper	50
ALCLK10	Crimp Link	10.0mm ²	-	Copper	50
ALCL1.5M5	Crimp Lug	1.5mm ²	5mm	Copper	100
ALCL1.5M6	Crimp Lug	1.5mm ²	6mm	Copper	100
ALCL2.5M4	Crimp Lug	2.5mm ²	4mm	Copper	100
ALCL2.5M5	Crimp Lug	2.5mm ²	5mm	Copper	100
ALCL6M8	Crimp Lug	6.0mm ²	8mm	Copper	50
ALCL10M8	Crimp Lug	10.0mm ²	8mm	Copper	25

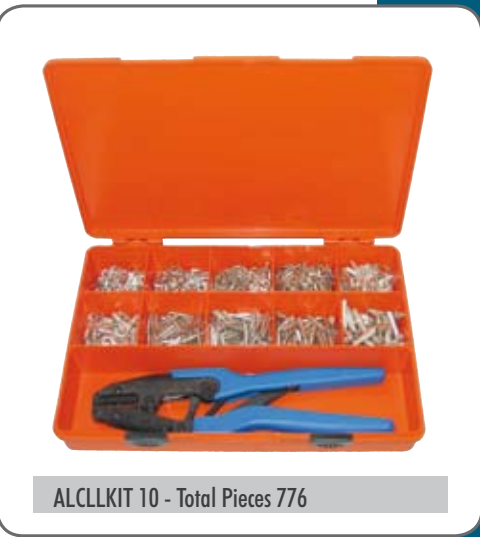

ALCLLKIT 10 - Total Pieces 776

Terminals Lugs and Links Mixed Kit			ALCPTLLKIT 18		
Part No.	Description	Conductor Size	Stud Size	Colour	QTY
WATMEB10OCW	Crimping Pliers	-	-	-	1
ALCRR4	Ring Terminal	0.5-1.5mm ²	4mm	Red	20
ALCRR5	Ring Terminal	0.5-1.5mm ²	5mm	Red	20
ALCRB4	Ring Terminal	1.5-2.5mm ²	4mm	Blue	20
ALCRB5	Ring Terminal	1.5-2.5mm ²	5mm	Blue	20
ALCFR4	Fork Terminal	0.5-1.5mm ²	4mm	Red	20
ALCFB4	Fork Terminal	1.5-2.5mm ²	4mm	Blue	20
ALCSPLR	Splice Terminal	0.5-1.5mm ²	-	Red	20
ALCSPLB	Splice Terminal	1.5-2.5mm ²	-	Blue	20
ALCMDTABR	Tabs Disconnect	0.5-1.5mm ²	-	Red	20
ALCMDTABB	Tabs Disconnect	1.5-2.5mm ²	-	Blue	20
ALCFIFQDR	Quick Disconnect	0.5-1.5mm ²	-	Red	20
ALCFIFQDB	Quick Disconnect	1.5-2.5mm ²	-	Blue	20
ALCLK1.5	Crimp Link	1.5mm ²	-	Copper	20
ALCL1.5M4	Crimp Lug	1.5mm ²	4mm	Copper	20
ALCLK2.5	Crimp Link	2.5mm ²	-	Copper	20
ALCL2.5M4	Crimp Lug	2.5mm ²	4mm	Copper	20
ALCLK4	Crimp Link	4.0mm ²	-	Copper	20
ALCL4M4	Crimp Lug	4.0mm ²	4mm	Copper	20



ALCPTLLKIT18 - Total Pieces 361

Voltage Level:

- U₀/U (U_m) 0.6/1 (1.2) kV

Applications:

- Indoor
- Underground
- Outdoor
- Cable trays

Product Supplied with:

- Inner tubes
- Cleaning tissue
- Fire resistant tubes
- Emery cloth
- Outer tube
- Easy-to-follow illustrated mounting instructions

Features

- For fire-resistant cable
- Halogen-free
- Compact dimensions
- Silicone-free
- Watertight
- Unlimited shelf life
- Resistant to UV-radiation, alkaline earths and chemical agents
- Low smoke emission
- High electrical insulation values

Approvals:



- DIN VDE 0472, part 814 (FE 180)
- IEC 331 - 332
- DIN 4102, part 12, concept February 1996 (E90)

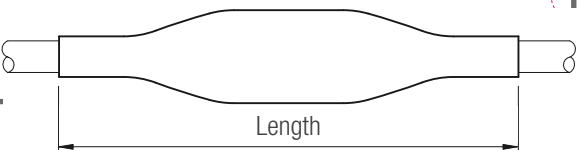

Suitable for connecting fire-resistant cables, wherever required, e.g. power plants, chemical plants, buildings, airports, tunnels, fire alarm systems, escape ways etc.

Dimensions

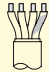

Part No	Type	Length (mm)	Max Cross Section per conductor (mm ²)		
			Plastic Insulated Cable		Concentric Conductor
					
			4x	5x	4x
HSJP4X1.5-4	SMH4 1.5-4 E90	350	1.5-4	-	-
HSJP4X06-10	SMH4 6-10 E90	380	6-10	-	-
HSJP4X16-25	SMH4 16-25 E90	470	16-25	-	-
HSJP4X35-50	SMH4 35-50 E90	500	35-50	-	-
HSJP4X70-95	SMH4 70-95 E90	600	70-95	-	-
HSJP4X120-150	SMH4 120-150 E90	600	120-150	-	-
HSJP4X185-240	SMH4 185-240 E90	750	185-240	-	-
HSJP5X1.5-4	SMH5 1.5-4 E90	350	-	1.5-4	-
HSSP5X06-10	SMH5 6-10 E90	380	-	6-10	-
HSJP5X16-25	SMH5 16-25 E90	470	-	16-25	-
HSJC4X1.5-4	SMHC4 1.5-4 E90	350	-	-	1.5-4
HSJC4X06-10	SMHC4 6-10 E90	380	-	-	6-10
HSJC4X16-25	SMHC4 16-25 E90	470	-	-	16-25
HSJC4X35-50	SMHC4 35-50 E90	500	-	-	35-50
HSJC4X70-95	SMHC4 70-95 E90	600	-	-	70-95
HSJC4X120-150	SMHC4 120-150 E90	600	-	-	120-150
HSJC4X185-240	SMHC4 185-240 E90	750	-	-	185-240

Note: Connectors must be ordered separately. Lead times apply.

Features

- Medium Wall
- Silicone-free
- UV-resistant
- Non-corrosive
- Halogen-free
- Excellent chemical & electrical properties
- Flame retardant, resistant to cold flow
- High tensile strength
- Maximum internal pressure 1.5 bar
- With hot melting adhesive
- With adhesive and stainless steel channel

Material

- Cross-linked polyolefin
- Free of lead and cadmium

Colour

- Black

Part No	Type	Length	Internal Diameter		Application		Recovered Wall Thickness
			before shrinkage	after shrinkage	min shrinkage	max shrinkage	
		(mm)	(mm)		(mm)		(mm)
HSRS28-10	SRMAHV 28-10	500	32	10	10	28	2.3
HSRS43-12	SRMAHV 43-12	500	52	12	12	43	3.4
HSRS72-18	SRMAHV 72-18	500	82	18	18	72	3.4
HSRS93-26	SRMAHV 93-26	500	105	26	26	93	3.4
HSRS115-30	SRMAHV 115-30	500	130	30	30	115	2.3
HSRS125-32	SRMAHV 125-32	500	143	32	32	125	2.3
HSRS150-50	SRMAHV 150-50	500	180	50	50	150	2.3

Note: Other lengths available upon request



Suitable for quick sealing and cable repair

Technical Data	Value	Test Method
Physical properties		
Density	~ 1.05 g/cm ³	DIN 53 479
Hardness	< 50 Shore D	DIN 53 505
Elongation at break	300%	EN ISO 527-2
Tensile strength	13 MPa	EN ISO 527-2
Longitudinal shrinkage	< 10%	CP-PM 1013*
Shrink ratio	> 3:1	-
Thermal properties		
Operating temperature range	-40 °C to +120 °C	DIN 53 446
Shrinking temperature	> 125 °C	CP-PM-1004*
Burning behaviour	non self-extinguishing	ASTM-D 876
Flexibility at low temperatures	-40 °C	ASTM 2671 C
Thermal ageing (168hrs at 150 °C)	350%	EN ISO 527-2
Elongation at break	14 MPa	
Tensile strength		
Electrical properties		
Dielectric strength	12 kV/mm	DIN VDE 0303 P.2
Volume resistivity	10 ¹⁴ Ω x cm	DIN VDE 0303 P.3
Dielectric constant	~ 5	DIN VDE 0303 P.3
Chemical properties		
Corrosion	none	ASTM 2671
Water absorption	< 0.15%	DIN 53 495 1L
Resistance to fungus and decay	Ratio 1	ISO 846 Meth. A



Copper Crimp Lugs

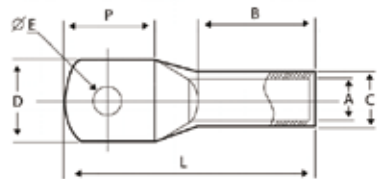

Lugs - Dimensions

Lugs													
Part No	Conductor Size (mm²)	Stud Size ØE (mm)	Stranding Metric	Dimensions (mm)						Pack QTY	Recommended Heatshrink		
				A	C	D	P	B	L		Thin Wall	Medium Wall	Thick Wall
ALCL1.5M4/100	1.5	4	1/1.38	1.8	3.7	8	9	7	18	100	HSTNW7.0/3.55	HSMWGL10/3	HSTKWGL13/4
ALCL1.5M5/100	1.5	5	1/1.38	1.8	3.7	9	10	7	19	100	HSTNW7.0/3.55	HSMWGL10/3	HSTKWGL13/4
ALCL1.5M6/100	1.5	6	1/1.38	1.8	3.7	9	11	7	20	100	HSTNW7.0/3.55	HSMWGL10/3	HSTKWGL13/4
ALCL2.5M4/100	2.5	4	7/0.67	2.4	4.0	8	9	7	18	100	HSTNW7.0/3.55	HSMWGL10/3	HSTKWGL13/4
ALCL2.5M5/100	2.5	5	7/0.67	2.4	4.0	8	10	7	18	100	HSTNW7.0/3.55	HSMWGL10/3	HSTKWGL13/4
ALCL2.5M6/100	2.5	6	7/0.67	2.4	4.0	10	12	7	20	100	HSTNW7.0/3.55	HSMWGL10/3	HSTKWGL13/4
ALCL2.5M8/100	2.5	8	7/0.67	2.4	4.0	11	16	9	26	100	HSTNW7.0/3.55	HSMWGL10/3	HSTKWGL13/4
ALCL4M5/100	4	5	7/0.85	3.1	4.8	11	12	9	22	100	HSTNW7.0/3.55	HSMWGL10/3	HSTKWGL13/4
ALCL4M6/100	4	6	7/0.85	3.1	4.8	11	12	9	22	100	HSTNW7.0/3.55	HSMWGL10/3	HSTKWGL13/4
ALCL4M8/100	4	8	7/0.85	3.1	4.8	11	16	11	29	100	HSTNW7.0/3.55	HSMWGL10/3	HSTKWGL13/4
ALCL6M6/50	6	6	7/1.04	3.8	5.5	10	11	12	26	50	HSTNW10.0/5.0	HSMWGL10/3	HSTKWGL13/4
ALCL6M8/50	6	8	7/1.04	3.8	5.5	12	16	12	31	50	HSTNW10.0/5.0	HSMWGL16/5	HSTKWGL13/4
ALCL6M10/50	6	10	7/1.04	3.8	5.5	17	23	12	39	50	HSTNW10.0/5.0	HSMWGL16/5	HSTKWGL19/6
ALCL10M6/25	10	6	7/1.35	4.5	6.9	12	14	11	28	25	HSTNW13/6.5	HSMWGL16/5	HSTKWGL13/4
ALCL10M8/25	10	8	7/1.35	4.5	6.9	12	16	11	30	25	HSTNW13/6.5	HSMWGL16/5	HSTKWGL13/4
ALCL10M10/25	10	10	7/1.35	4.5	6.9	17	20	11	35	25	HSTNW13/6.5	HSMWGL16/5	HSTKWGL19/6
ALCL10M12/25	10	12	7/1.35	4.5	6.9	17	20	11	35	25	HSTNW13/6.5	HSMWGL16/5	HSTKWGL19/6
ALCL16M6/25	16	6	7/1.70	5.9	8.0	12	15	20	39	25	HSTNW13/6.5	HSMWGL16/5	HSTKWGL13/4
ALCL16M8/25	16	8	7/1.70	5.9	8.0	12	15	20	39	25	HSTNW13/6.5	HSMWGL16/5	HSTKWGL13/4
ALCL16M10/25	16	10	7/1.70	5.9	8.0	17	26	20	50	25	HSTNW13/6.5	HSMWGL16/5	HSTKWGL19/6
ALCL16M12/25	16	12	7/1.70	5.9	8.0	17	26	20	50	25	HSTNW13/6.5	HSMWGL16/5	HSTKWGL19/6
ALCL25M6/25	25	6	19/1.35	7.0	9.7	14	16	23	42	25	HSTNW13/6.5	HSMWGL16/5	HSTKWGL19/6
ALCL25M8/25	25	8	19/1.35	7.0	9.7	14	16	23	42	25	HSTNW13/6.5	HSMWGL16/5	HSTKWGL19/6
ALCL25M10/25	25	10	19/1.35	7.0	9.7	19	23	23	50	25	HSTNW18/9	HSMWGL25/8	HSTKWGL19/6
ALCL25M12/25	25	12	19/1.35	7.0	9.7	19	23	23	50	25	HSTNW18/9	HSMWGL25/8	HSTKWGL19/6
ALCL35M6/25	35	6	19/1.53	8.4	11.5	16	19	23	46	25	HSTNW18/9	HSMWGL25/8	HSTKWGL19/6
ALCL35M8/25	35	8	19/1.53	8.4	11.5	16	19	23	46	25	HSTNW18/9	HSMWGL25/8	HSTKWGL19/6
ALCL35M10/25	35	10	19/1.53	8.4	11.5	16	19	23	46	25	HSTNW18/9	HSMWGL25/8	HSTKWGL19/6
ALCL35M12/25	35	12	19/1.53	8.4	11.5	19	27	23	53	25	HSTNW18/9	HSMWGL25/8	HSTKWGL19/6
ALCL35M8/25	35	-	19/1.53	8.4	11.5	19	27	23	53	25	HSTNW18/9	HSMWGL25/8	HSTKWGL19/6
ALCL50M8/10	50	8	19/1.78	9.5	12.7	18	20	23	49	10	HSTNW18/9	HSMWGL25/8	HSTKWGL19/6
ALCL50M10/10	50	10	19/1.78	9.5	12.7	18	20	23	49	10	HSTNW18/9	HSMWGL25/8	HSTKWGL19/6
ALCL50M12/10	50	12	19/1.78	9.5	12.7	18	20	23	49	10	HSTNW18/9	HSMWGL25/8	HSTKWGL19/6
ALCL70M8/10	70	8	19/2.14	11.1	14.3	20	23	24	54	10	HSTNW18/9	HSMWGL25/8	HSTKWGL19/6
ALCL70M10/10	70	10	19/2.14	11.1	14.3	20	23	24	54	10	HSTNW18/9	HSMWGL25/8	HSTKWGL19/6
ALCL70M12/10	70	12	19/2.14	11.1	14.3	20	23	24	54	10	HSTNW18/9	HSMWGL25/8	HSTKWGL19/6
ALCL70M16/10	70	16	19/2.14	11.1	14.3	25	33	24	64	10	HSTNW22/11	HSMWGL25/8	HSTKWGL28/9
ALCL95M8/10	95	8	37/1.78	13.5	17.5	25	27	25	60	10	HSTNW22/11	HSMWGL25/8	HSTKWGL28/9
ALCL95M10/10	95	10	37/1.78	13.5	17.5	25	27	25	60	10	HSTNW22/11	HSMWGL25/8	HSTKWGL28/9
ALCL95M12/10	95	12	37/1.78	13.5	17.5	25	27	25	60	10	HSTNW22/11	HSMWGL25/8	HSTKWGL28/9
ALCL95M16/10	95	16	37/1.78	13.5	17.5	25	33	25	65	10	HSTNW22/11	HSMWGL25/8	HSTKWGL28/9

Note: Thin wall range of heatshrink available in a range of different colours

Lugs													
Part No	Conductor Size (mm²)	Stud Size ØE (mm)	Stranding Metric	Dimensions (mm)						Pack QTY	Recommended Heatshrink		
				A	C	D	P	B	L		Thin Wall	Medium Wall	Thick Wall
ALCL120M10/10	120	10	37/2.03	15.5	20.6	29	29	32	70	10	HSTNW40/20	HSMWGL35/12	HSTKWGL28/9
ALCL120M12/10	120	12	37/2.03	15.5	20.6	29	29	32	70	10	HSTNW40/20	HSMWGL35/12	HSTKWGL28/9
ALCL120M16/10	120	16	37/2.03	15.5	20.6	29	32	32	75	10	HSTNW40/20	HSMWGL35/12	HSTKWGL28/9
ALCL150M10/10	150	10	37/2.25	16.3	22.2	31	34	32	78	10	HSTNW40/20	HSMWGL35/12	HSTKWGL38/12
ALCL150M12/10	150	12	37/2.25	16.3	22.2	31	34	32	78	10	HSTNW40/20	HSMWGL35/12	HSTKWGL38/12
ALCL150M16/10	150	16	37/2.25	16.3	22.2	31	34	32	78	10	HSTNW40/20	HSMWGL35/12	HSTKWGL38/12
ALCL185M10/6	185	10	37/2.52	18.3	24.3	34	35	32	82	6	HSTNW40/20	HSMWGL35/12	HSTKWGL38/12
ALCL185M12/6	185	12	37/2.52	18.3	24.3	34	35	32	82	6	HSTNW40/20	HSMWGL35/12	HSTKWGL38/12
ALCL185M16/6	185	16	37/2.52	18.3	24.3	34	35	32	82	6	HSTNW40/20	HSMWGL35/12	HSTKWGL38/12
ALCL240M8/6	240	8	61/2.25	21.2	28.6	40	41	42	99	6	HSTNW40/20	HSMWGL50/16	HSTKWGL51/16
ALCL240M12/6	240	12	61/2.25	21.2	28.6	40	41	42	99	6	HSTNW40/20	HSMWGL50/16	HSTKWGL51/16
ALCL240M16/6	240	16	61/2.25	21.2	28.6	40	41	42	99	6	HSTNW40/20	HSMWGL50/16	HSTKWGL51/16
ALCL240M20/6	240	20	61/2.25	21.2	28.6	40	41	42	99	6	HSTNW40/20	HSMWGL50/16	HSTKWGL51/16
ALCL240MB/6	240	-	61/2.25	21.2	28.6	40	41	42	99	6	HSTNW40/20	HSMWGL50/16	HSTKWGL51/16
ALCL300MB/3	300	-	61/2.52	23.8	31.9	45	45	47	107	3	HSTNW40/20	HSMWGL50/16	HSTKWGL51/16
ALCL400MB/3	400	-	61/2.85	26.8	34.8	49	51	48	116	3	HSTNW50/25	HSMWGL50/16	HSTKWGL51/16
ALCL500MB/3	500	-	61/3.20	30.0	38.0	55	60	50	130	3	HSTNW50/25	HSMWGL85/25	HSTKWGL68/22
ALCL630MB/3	630	-	127/2.52	33.5	45.0	64	65	57	146	3	HSTNW70/35	HSMWGL85/25	HSTKWGL68/22

Links													
Part No	Conductor Size (mm²)	Stranding Metric	Dimensions (mm)			Pack QTY	Recommended Heatshrink						
			A	C	L		Thin Wall	Medium Wall	Thick Wall				
ALCLK1.5/100	1.5	1/0.80	2.1	3.8	15	100	HSTNW7.0/3.55	HSMWGL10/3	HSTKWGL13/4				
ALCLK2.5/100	2.5	7/0.67	2.5	4.0	22	100	HSTNW7.0/3.55	HSMWGL10/3	HSTKWGL13/4				
ALCLK4/100	4	7/0.85	3.1	4.8	22	100	HSTNW7.0/3.55	HSMWGL10/3	HSTKWGL13/4				
ALCLK6/50	6	7/1.04	3.8	5.5	22	50	HSTNW7.0/3.55	HSMWGL10/3	HSTKWGL13/4				
ALCLK10/50	10	7/1.35	4.5	6.9	26	50	HSTNW10.0/5.0	HSMWGL10/3	HSTKWGL13/4				
ALCLK16/25	16	7/1.70	5.9	8.0	36	25	HSTNW10.0/5.0	HSMWGL10/3	HSTKWGL13/4				
ALCLK25/25	25	19/1.35	7.0	9.7	47	25	HSTNW13/6.5	HSMWGL16/5	HSTKWGL19/6				
ALCLK35/25	35	19/1.53	8.4	11.5	47	25	HSTNW18/9	HSMWGL16/5	HSTKWGL19/6				
ALCLK50/25	50	19/1.78	9.5	12.7	47	25	HSTNW18/9	HSMWGL16/5	HSTKWGL38/12				
ALCLK70/10	70	19/2.14	11.1	14.3	54	10	HSTNW18/9	HSMWGL25/8	HSTKWGL28/9				
ALCLK95/10	95	37/1.78	13.5	17.5	54	10	HSTNW22/11	HSMWGL25/8	HSTKWGL28/9				
ALCLK120/10	120	37/2.03	15.5	20.6	68	10	HSTNW40/20	HSMWGL35/12	HSTKWGL38/12				
ALCLK150/6	150	37/2.25	16.3	22.2	68	6	HSTNW40/20	HSMWGL35/12	HSTKWGL38/12				
ALCLK185/6	185	37/2.52	18.3	24.3	68	6	HSTNW40/20	HSMWGL35/12	HSTKWGL38/12				
ALCLK240/6	240	61/2.25	21.2	28.6	88	6	HSTNW50/25	HSMWGL50/16	HSTKWGL51/16				
ALCLK300/3	300	61/2.52	23.8	31.9	98	3	HSTNW50/25	HSMWGL50/16	HSTKWGL51/16				
ALCLK400/3	400	61/2.85	26.8	34.8	98	3	HSTNW70/35	HSMWGL50/16	HSTKWGL68/22				
ALCLK500/3	500	61/3.20	30.0	38.0	98	3	HSTNW70/35	HSMWGL85/12	HSTKWGL68/22				
ALCLK630/3	630	127/2.52	33.5	45.0	101	3	HSTNW70/35	HSMWGL85/12	HSTKWGL90/30				



Copper Crimp Links

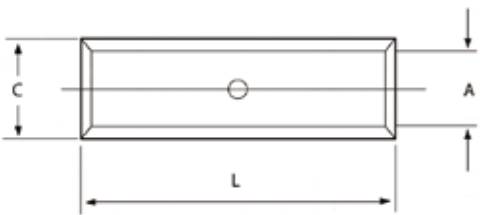

Links - Dimensions

Note: Thin wall range of heatshrink available in a range of different colours



Alco's Cast Resin is ideal for single or multi-core cable networks. We offer a number of resin systems such as straight through cable joints, branch off joints and two part resin packs.

Resin joints can be used in applications where cables are buried directly in the ground, submerged in water or under maintenance. The standard moulds used are made from thermoplastic materials that provide excellent mechanical stability and high resistance to water and termites. The moulds are transparent allowing you to see the cable connection during casting. All resin joints comply with VDE standards and are watertight, ideal for water-submerged applications. No other insulation of the cable joint is necessary eg heatshrink, tapes etc. The cast resin is all that is required.

The resin is supplied in a two-chamber mixing bag that allows it to be poured easily after it is mixed. The bags are made from a three-layer aluminium plastic laminate material. One of the key features of the mixing bag is the quick pull off parting rail, which when removed allows the hardener and resin to be mixed in the one bag, eliminating external dirt or foreign materials. After pouring, the bag can be disposed of safely in any household rubbish bin.

Voltage Level:

- $U_o / U (U_m)$ 0.6/1 (1.2) kV

Applications:

- Indoor
- Underground
- Outdoor
- Cable trays
- Water

Product Supplied with:

- Transparent mould
- Lid and spacer plate (Type M11 - M16)
- Funnel (Type MZ00 and MZ0)
- Sealing tape
- Gloves
- Illustrated easy-to-follow mounting instructions
- Hydrolysis resistant PUR type EG cast-resin, containing the correct volume needed ready for mixing, in handy two chamber mixing bag

Features:

- Large insertion opening for easy casting
- High electrical insulation value
- Watertight
- Compact size
- High mechanical strength
- Standard resin can be stored for up to 40 months
- High quality, transparent and shockproof plastic mould
- Visible splice position before casting
- Extremely quick and easy to use, saving time and money
- Resistant to UV-radiation, alkaline earths and chemical agents
- Ready for immediate use

Approvals:

- DIN VDE 0278 part 1 and 3
- DIN VDE 0278 part 393
- EN 50393 as well as CENELEC HD 623 (VDE 0278, part 623)



Practical two chamber mixing bag

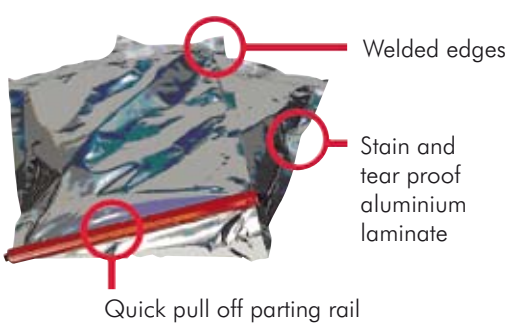

Suitable for connecting low voltage plastic insulated cables or PVC, PE, VPE and EPR insulated conductors.

Type M Cast Resin

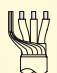
Part No	Type	Cable Diameter (mm)	Dimensions (mm)			Max Cross Section per Conductor (mm²)		
			L	D	H	Plastic Insulated Cable	Concentric Conductor	Armoured
						 4x	 3x	 4x
ALC124M11	M 11	26	190	36	50	10	10/10	-
ALC124M12	M 12	34	260	47	63	25	25/25	-
ALC124M13	M 13	43	360	55	75	50	50/50	35
ALC124M14	M 14	48	400	70	95	95	95/95	70
ALC124M15	M 15	63	530	100	120	150	150/150	120
ALC124M16	M 16	81	700	125	160	240	240/120	240

Type MZ Cast Resin

Part No	Type	Cable Diameter (mm)	Dimensions (mm)			Wire Diameter (mm)				
			L	D	H	0.4	0.6	0.8	1.5	2.5
						No of Pairs			No of conductors	
ALC124MZ00	MZ00	20	180	23	35	10-15	5-10	5-10	7	5
ALC124MZ0	MZ0	25	250	35	55	15-30	10-20	10-20	15	10

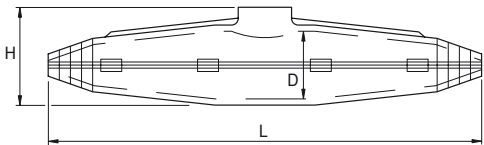

Type M11-M16

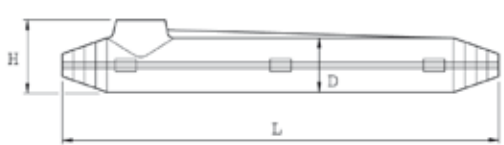

Type MZ00-MZ0

Dimensions

This information applies to Type M and Type MZ Products (Unless otherwise stated)

Voltage level

- U₀ / U (U_m) 0.6/1 (1.2) kV

Applications

- Indoor
- Outdoor
- Underground
- Water
- Cable trays

Product Supplied with:

- Sealing tape
- Transparent moulds
- Illustrated easy-to-follow mounting instructions
- Filling in funnel
- Air release funnel (Except Type Y 00)
- Gloves
- Closing stops
- Hydrolysis resistant PUR type EG cast-resin, containing the correct volume needed ready for mixing, in handy two chamber mixing bag

Features

- Watertight
- High electrical insulation values
- High mechanical strength
- Compact size
- Standard resin can be stored for up to 40 months
- Large insertion opening for easy casting
- High quality transparent and shockproof plastic mould
- Visible splice position before casting
- Extremely quick and easy to use, saving time and money
- Resistant to UV-radiation, alkaline earths and chemical agents
- Ready for immediate use

Approvals:

- DIN VDE 0278 part 1 and 3
- DIN VDE 0278 part 393
- EN 50393 as well as CENELEC HD 623 (VDE 0278, part 623)

Note

- For joint sizes Y 3 and above, branch-off ring connectors can be used

Cast Resin Type 'EG' is suitable for the following types of cables:

- Low-voltage plastic-insulated and paper-insulated cables rated up to 1kV
- Telecommunications and signal plastic-insulated and paper-insulated cables

Features

- Suitable for mechanical protection and water-sealing on medium voltage cables
- Halogen-free unfilled two-component polyurethane cast-resin
- Specially developed for cable joints
- No toxic emission during mixing and casting
- Excellent hydrolytical resistance
- No cracks during electrical and mechanical stress
- Excellent flow properties
- Low hardening temperature
- Packed in practical and easy-to-use two chamber mixing bags
- Fast hardening
- Good adherence to all cable materials

Approvals:

- Governmental Material Test Laboratory Darmstadt: DIN VDE 0291
- KEMA, Netherland: Report on the MAK value, which lies well below the maximum value of 0.01 ppm, allowed by law

Storage conditions

- Store at optimum temperature of +15°C to +35°C for up to 40 months in original aluminium bag

Suitable for connecting low voltage plastic insulated cables or PVC, PE, VPE & EPR insulated conductors.

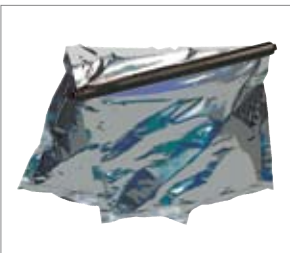
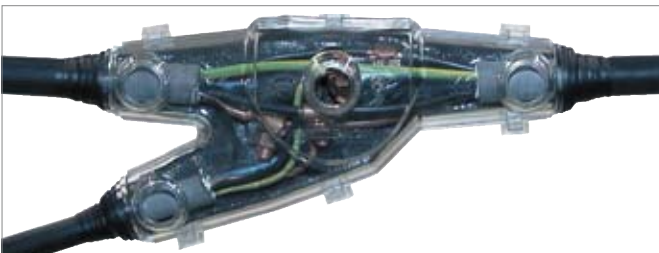

Type Y Cast Resin

Part No	Type	Dimensions				Cable Diameter		Max Cross Section per Conductor (mm²)					
		L (mm)	B (mm)	D (mm)	H (mm)	main cable (mm)	branch cable (mm)	Plastic Insulated Cable				Concentric Conductor	
								5x	3x	4x		3x	
ALC133Y00	Y 00	150	75	38	50	23	23			-	-	-	-
ALC152Y0	Y 0	185	80	45	55	17	17	-	-	4	4	4/4	4/4
ALC124Y1	Y 1	240	110	60	70	22	22	-	-	10	4	10/10	10/10
ALC147Y2	Y 2	285	120	65	75	37	33	-	-	35	16	16/16	10/10
ALC131Y3	Y 3	240	145	100	110	42	37	-	-	50	35	25/25	16/16
ALC131Y3.5	Y 3 1/2	300	150	110	120	54	38	-	-	50	35	35/35	25/25
ALC124Y4	Y 4	285	170	110	120	53	37	-	-	95	50	70/70	25/25
ALC131Y4.5	Y 4 1/2	335	193	120	130	56	42	-	-	150	70	120/120	95/95
ALC157Y5	Y 5	382	220	140	150	62	52	-	-	240	95	150/150	95/95
ALC131Y6	Y 6	570	275	180	190	90	80	-	-	300	185	240/120	185/95

Y3, Y4, Y41/2

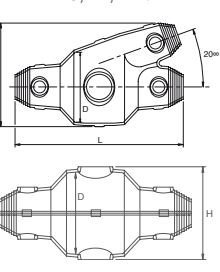

Y00 - Y2, Y31/2, Y5, Y6

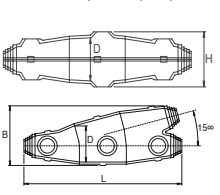

Dimensions

Type 'EG' 2-component PUR Resin

Features	Value	Requirements for cast-resins according to DIN VDE 0291, part 2 (draft 1997)		
		GNW/RLS	GMW/RMS	GFW/RTS
Cast-resin component / open cup flash point	> 200 °C	> 100 °C	-	> 100 °C
Reactant / open cup flash point	> 200 °C	> 55 °C	-	> 55 °C
Processing time (potlife), preparation 300 ml 5 °C 23 °C 35 °C	35 minutes 20 minutes 15 minutes	conformity to manufacturer's data (± 30%)		
Gel time for 300 ml at 23 °C Bag < 1000 ml Bag > 1000 ml	17 minutes 26 minutes	conformity to manufacturer's data (± 10%)		
Maximum reaction temperature	98 °C/371 K	conformity to manufacturer's data (± 10K)		
Total volume contraction during hardening	6%	max 6.5%		
Density	1.1 g/cm³	-		
Impact strength	> 10 kJ/m²	> 10 kJ/m²		
Hardness	54 Shore D	min. 20 Shore D		
Thermal expansion coefficient in the temperature range of 20-50 °C	5.9 x 10⁻⁴ K⁻¹	conformity to manufacturer's data (± 15%)		
Thermal conductivity	0.2 W x M⁻¹ x K⁻¹	conformity to manufacturer's data (± 20%)		
Combustibility	class IIC	according to DIN VDE 0304, part 3		
Water absorption in warm water (42days at 50 °C)	350 mg	max 600 mg	max 400 mg	max 600 mg
Electrolytic corrosion	A1	< A1.4	-	< A1.4
1 minute test voltage at 23 °C at 80 °C	- > 20 kV > 10 kV	no breakdown at test voltage		
Dielectric dissipation factor at 23 °C and 50 Hz at 23 °C and 1 kHz	0.07 0.05	10 kV 10 kV	20 kV 20 kV	10 kV -
Relative permittivity at 23 °C and 50 Hz at 23 °C and 1 kHz	5 5.1	-	< 6 -	- max 6
Tracking resistance	KA 3c	min KA 3b	min KA 3c	-
Hydrolysis resistance after water immersion (28days at 90 °C)	8.2 N/mm² 60% 47 Shore D	≥ 65% of initial value ≥ 65% of initial value ≥ 80% of initial value		

Type 'EG' Standard Cast Resin

Part No	Type	Volume (ml)
ALC124EG80	EG 80	80
ALC124EG143	EG 143	143
ALC124EG286	EG 286	286
ALC124EG370	EG 370	370
ALC124EG464	EG 464	464
ALC124EG730	EG 730	730
ALC124EG1000	EG 1000	1000
ALC124EG1150	EG 1150	1150
ALC124EG1500	EG 1500	1500
ALC124EG2000	EG 2000	2000

Note: Technical Data for this product is also suitable for resin supplied with Type 'M' and Type 'Y' product ranges



Cast resin Type 'KG' is a specially developed two-component polyurethan (PUR) cast-resin for isolating cable connections. This transparent removable crumbly cast-resin allows sight control of the connection after filling. The connection can be released at any time by simply removing the resin. Typical applications include: cable branch-off cabinets, connection boxes, communication cable connections, electronic components, etc.

Features

- Favourable flow properties
- Halogen-free unfilled two-component polyurethane cast-resin
- Resin remains transparent after hardening
- Good adherence to all cable materials
- No cracks during electrical stress
- Low hardening temperature
- Excellent hydrolytic resistance
- No toxic emission during mixing and casting
- Packed in practical and easy-to-use two chamber mixing bags

Approval

- According to DIN VDE 0291 part 2 (draft 6/97)

Storage conditions

- Store at optimum temperature of +15 °C to +35 °C for up to 24 months in the original aluminium bag

Type 'KG' 2-component PUR Resin, Removable Crumbly Type

Features	Value
Reactive mass	
Viscosity (20°C)	1000 mPa x s
Processing time (20°C)	ca. 1hr
Maximum temperature	< 40 °C
Cast-resin moulding material	
Density	1 g/cm ³
Hardness	10 Shore A
Spec. volume resistance	2 x 10 ¹⁰ Ω x cm
Tensile strength	7 N/cm ²
Elongation at break	10%
Water absorption in cold water (24hrs at 23 °C)	30 mg
Water absorption in warm water (42days at 50 °C)	188 mg
1 minute test voltage at 23 °C	> 20 kV
at 80 °C	> 10 kV

Part No	Type	Volume (ml)
ALC125KG143	KG 143	143
ALC125KG286	KG 286	286
ALC125KG730	KG 730	730

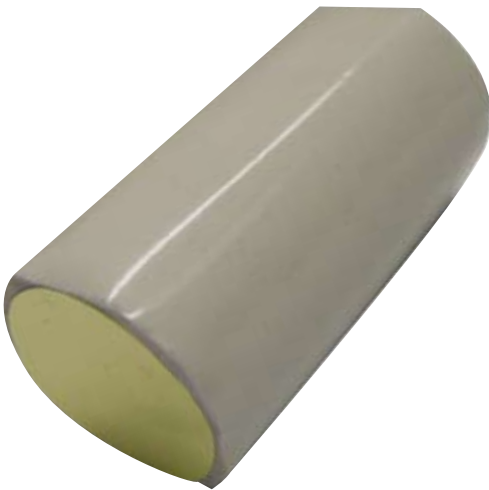

ALCIP38



WATIP180



Weatherproof quick boxes

38mm Insulputty

- Alco epoxy sealing compound is designed for use with Alco barrier glands
- Working life of approximately 40 minutes
- Compound should be mixed for about 3 minutes by folding and kneading until the mixture is uniform in colour
- Used for filling and sealing where there are uneven contours
- Also used for hole filling and bonding

Specifications

Part No.	ALCIP38
Length:	38mm
Storage:	Store in a cool, dry place
Electrical Resistance:	30,000MΩ (ASTM D 149)
Dielectric Strength:	300v/mm at 6.4mm (ASTM D 149)
Shrinkage during cure:	< 1%

180mm Insulputty

- Two part epoxy putty with excellent mechanical and electrical characteristics
- Ready mixable and workable for 40 minutes
- Cures within 1 hour
- Used for filling and sealing where there are uneven contours
- Cured material can be sanded and drilled

Specifications

Part No.	WATIP180
Length:	180mm
Storage:	Store in a cool, dry place
Electrical Resistance:	30,000MΩ (ASTM D 149)
Dielectric Strength:	300v/mm at 6.4mm (ASTM D 149)
Shrinkage during cure:	< 1%

Weatherproof Quick Boxes

- UV stabilised PVC material
- Water and dust resistant
- IP56 degree of protection
- Compliance with AS1939-1990

Specifications

Part No.	Dimensions	Internal Dimensions	Colour
ALCWQB-0	105 x 105 x 72mm	72 x 72 x 50mm	Grey
ALCWQB-1	120 x 85 x 72mm	87 x 52 x 50mm	Grey
ALCWQB-2	120 x 120 x 93mm	87 x 52 x 50mm	Grey
ALCWQB-3	160 x 120 x 93mm	152 x 87 x 70mm	Grey
ALCWQB-4	230 x 120 x 72mm	152 x 87 x 70mm	Grey

See page 21 for Sealing Kit information

See page 21 for Sealing Kit information

Junction Boxes			
Part No.	Size (mm)	Colour	Image No.
ALCJB161	16mm 1W	Grey	1
ALCJB162	16mm 2W	Grey	2
ALCJB163	16mm 3W	Grey	3
ALCJB164	16mm 4W	Grey	4
ALCJB201	20mm 1W	Grey	5
ALCJB201D	20mm 1W D	Grey	6
ALCJB202	20mm 2W	Grey	7
ALCJB202A	20mm 2W 90°	Grey	8
W - way	D - deep	S - square	A-Angled 90°



Junction Boxes			
Part No.	Size (mm)	Colour	Image No.
ALCJB252	25mm 2W	Grey	17
ALCJB252A	25mm 2W 90°	Grey	18
ALCJB252D	25mm 2W D	Grey	19
ALCJB252DA	25mm 2W D 90°	Grey	20
ALCJB253	25mm 3W	Grey	21
ALCJB253D	25mm 3W D	Grey	22
ALCJB254	25mm 4W	Grey	23
W - way	D - deep	S - square	A-Angled 90°



Junction Boxes			
Part No.	Size (mm)	Colour	Image No.
ALCJB202D	20mm 2W D	Grey	9
ALCJB202DA	20mm 2W D 90°	Grey	10
ALCJB203	20mm 3W	Grey	11
ALCJB203D	20mm 3W D	Grey	12
ALCJB204	20mm 4W	Grey	13
ALCJB204D	20mm 4W D	Grey	14
ALCJB251	25mm 1W	Grey	15
ALCJB251D	25mm 1W D	Grey	16
W - way	D - deep	S - square	A-Angled 90°

Junction Boxes/Accessories			
Part No.	Size (mm)	Colour	Image No.
ALCJB254D	25mm 4W D	Grey	24
ALCJB321	32mm 1W S	Grey	26
ALCJB322	32mm 2W S	Grey	26
ALCJB323	32mm 3W S	Grey	27
ALCJB324	32mm 4W S	Grey	28
ALCJBDL	Disposable Lid	Grey	29
ALCJBER25	25mm extension ring	Grey	30
W - way	D - deep	S - square	A-Angled 90°

Removable PUR Resin Sealing Kits

Sealing Kit Part No	Quickbox/Junction Box Part No	Removable filler		Insulputty sealer	
		part number	no. req	part number	no. req
ALCQJR161	ALCJB161	ALC125KG143	1	ALCIP38	1
ALCQJR162	ALCJB162	ALC125KG143	1	ALCIP38	1
ALCQJR163	ALCJB163	ALC125KG143	1	ALCIP38	1
ALCQJR164	ALCJB164	ALC125KG143	1	ALCIP38	1
ALCQJR201	ALCJB201	ALC125KG143	1	ALCIP38	1
ALCQJR201D	ALCJB201D	ALC125KG286	1	ALCIP38	1
ALCQJR202	ALCJB202	ALC125KG143	1	ALCIP38	1
ALCQJR202A	ALCJB202A	ALC125KG143	1	ALCIP38	1
ALCQJR202D	ALCJB202D	ALC125KG286	1	ALCIP38	1
ALCQJR202DA	ALCJB202DA	ALC125KG286	1	ALCIP38	1
ALCQJR203	ALCJB203	ALC125KG143	1	ALCIP38	1
ALCQJR203D	ALCJB203D	ALC125KG286	1	ALCIP38	1
ALCQJR204	ALCJB204	ALC125KG143	1	ALCIP38	1
ALCQJR204D	ALCJB204D	ALC125KG286	1	ALCIP38	1
ALCQJR251	ALCJB251	ALC125KG143	1	ALCIP38	1
ALCQJR251D	ALCJB251D	ALC125KG286	1	ALCIP38	1
ALCQJR252	ALCJB252	ALC125KG143	1	ALCIP38	1
ALCQJR252A	ALCJB252A	ALC125KG143	1	ALCIP38	1
ALCQJR252D	ALCJB252D	ALC125KG286	1	ALCIP38	1
ALCQJR252DA	ALCJB252DA	ALC125KG286	1	ALCIP38	1
ALCQJR253	ALCJB253	ALC125KG143	1	ALCIP38	2
ALCQJR253D	ALCJB253D	ALC125KG143	1	ALCIP38	2
ALCQJR254	ALCJB254	ALC125KG143	1	ALCIP38	2
ALCQJR254D	ALCJB254D	ALC125KG286	1	ALCIP38	2
ALCQJR321	ALCJB321	ALC125KG286	1	ALCIP38	1
ALCQJR322	ALCJB322	ALC125KG286	1	ALCIP38	2
ALCQJR323	ALCJB323	ALC125KG286	1	ALCIP38	3
ALCQJR324	ALCJB324	ALC125KG286	1	WATIP180	1
ALCQJRRER25	ALCJBER25	ALC125KG143	1	N/A	0
ALCQJRWQB0	ALCWQB-0	ALC125KG286	2	WATIP180	1
ALCQJRWQB1	ALCWQB-1	ALC125KG286	2	WATIP180	1
ALCQJRWQB2	ALCWQB-2	ALC125KG286	3	WATIP180	1
ALCQJRWQB3	ALCWQB-3	ALC125KG730	2	WATIP180	2
ALCQJRWQB4	ALCWQB-4	ALC125KG730	2	WATIP180	2

Non-Removable PUR Resin Sealing Kits

Sealing Kit Part No	Quickbox/ Junction Box Part No	Non-Removable filler		Insulputty sealer	
		part number	no. req	part number	no. req
ALCQJN161	ALCJB161	ALC124EG143	1	ALCIP38	1
ALCQJN162	ALCJB162	ALC124EG143	1	ALCIP38	1
ALCQJN163	ALCJB163	ALC124EG143	1	ALCIP38	1
ALCQJN164	ALCJB164	ALC124EG143	1	ALCIP38	1
ALCQJN201	ALCJB201	ALC124EG80	1	ALCIP38	1
ALCQJN201D	ALCJB201D	ALC124EG286	1	ALCIP38	1
ALCQJN202	ALCJB202	ALC124EG80	1	ALCIP38	1
ALCQJN202A	ALCJB202A	ALC124EG80	1	ALCIP38	1
ALCQJN202D	ALCJB202D	ALC124EG286	1	ALCIP38	1
ALCQJN202DA	ALCJB202DA	ALC124EG286	1	ALCIP38	1
ALCQJN203	ALCJB203	ALC124EG80	1	ALCIP38	1
ALCQJN203D	ALCJB203D	ALC124EG286	1	ALCIP38	1
ALCQJN204	ALCJB204	ALC124EG80	1	ALCIP38	1
ALCQJN204D	ALCJB204D	ALC124EG286	1	ALCIP38	1
ALCQJN251	ALCJB251	ALC124EG143	1	ALCIP38	1
ALCQJN251D	ALCJB251D	ALC124EG286	1	ALCIP38	1
ALCQJN252	ALCJB252	ALC124EG143	1	ALCIP38	1
ALCQJN252A	ALCJB252A	ALC124EG143	1	ALCIP38	1
ALCQJN252D	ALCJB252D	ALC124EG286	1	ALCIP38	1
ALCQJN252DA	ALCJB252DA	ALC124EG286	1	ALCIP38	1
ALCQJN253	ALCJB253	ALC124EG143	1	ALCIP38	2
ALCQJN253D	ALCJB253D	ALC124EG143	1	ALCIP38	2
ALCQJN254	ALCJB254	ALC124EG143	1	ALCIP38	2
ALCQJN254D	ALCJB254D	ALC124EG286	1	ALCIP38	2
ALCQJN321	ALCJB321	ALC124EG286	1	ALCIP38	1
ALCQJN322	ALCJB322	ALC124EG286	1	ALCIP38	2
ALCQJN323	ALCJB323	ALC124EG286	1	ALCIP38	3
ALCQJN324	ALCJB324	ALC124EG286	1	WATIP180	1
ALCQJNER25	ALCJBER25	ALC124EG80	1	N/A	0
ALCQJNWQB0	ALCWQB-0	ALC124EG464	1	WATIP180	1
ALCQJNWQB1	ALCWQB-1	ALC124EG464	1	WATIP180	1
ALCQJNWQB2	ALCWQB-2	ALC124EG1000	1	WATIP180	1
ALCQJNWQB3	ALCWQB-3	ALC124EG1500	1	WATIP180	2
ALCQJNWQB4	ALCWQB-4	ALC124EG1500	1	WATIP180	2

See page 21 for Sealing Kit information



Alco provides an extensive range of flexible conduit including PVC hose, corrugated and Anaconda flexible metal conduit. We also offer a full range of PVC rigid conduit fittings, junction boxes, quick boxes and accessories ranging from conduit bending springs and wire pulling products. To view our full range, please see our Flexible Conduit & Conduit Fittings Catalogue.

Simply call our service centre on 1300 300 747 for your FREE copy now!

Specialty Kit

Universal Cable Repair Kit			ALCRESKIT 1
Part No.	Description	Conductor Size	QTY
WATMH4NW	Ratchet Crimper	-	1
ALC124M11	Type M11 Cast Resin	-	4
ALCLK2.5/100	Crimp Link	2.5mm ²	100
ALCLK4/100	Crimp Link	4.0mm ²	100
ALCLK6/50	Crimp Link	6.0mm ²	50
ALCLK10/50	Crimp Link	10.0mm ²	50



ALCRESKIT1 - Total Pieces 305

Specialty Tapes



High Voltage Insulation Tape



Conducting Tape

Features				
• Highly conformable to irregular shapes				
• Retains conductivity when stretched				
• Good dielectrical and physical properties				
• High life cycle and operating security				
• Welds quickly to a homogeneous mass without cavities				
• Printed "CAUTION-CONDUCTING TAPE"				
• High heat resistance				
• Self-amalgamating and extremely ductile				
Specifications				
Part No.	Type	Thickness (mm)	Width (mm)	Length (m)
ALC125CONT61	No. 61	0.75	19	5

Features				
• For insulation of plastic cable conductors up to 69kV				
• Superior electrical, mechanical and thermal properties				
• High life cycle and operating security				
• Good dielectrical features				
• Self-amalgamating				
• Fully removable				
• Extremely weatherproof and ductile				
• Very good adhesive properties to a wide range of materials				
Specifications				
Part No.	Type	Thickness (mm)	Width (mm)	Length (m)
ALC125HVT60	No. 60	0.50	19	10
ALC145HVT62	No. 62	0.75	19	10

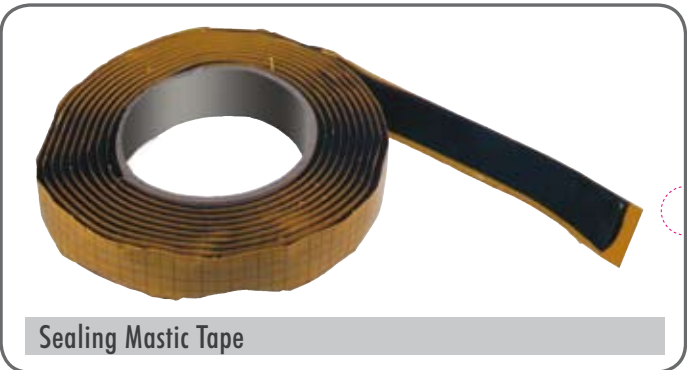

Sealing Mastic Tape

Features				
• Excellent adhesion and sealing characteristics to metals, glass, rubber and plastic				
• Improves sealing and cable terminations				
• Good dielectrical and physical properties				
• Durable				
• Quick and easy insulation and sealing of objects				
• Does not crack even after repeated flexing				
• Black in colour				
Specifications				
Part No.	Type	Thickness (mm)	Width (mm)	Length (m)
ALC127SMT	HKB	3	20	3

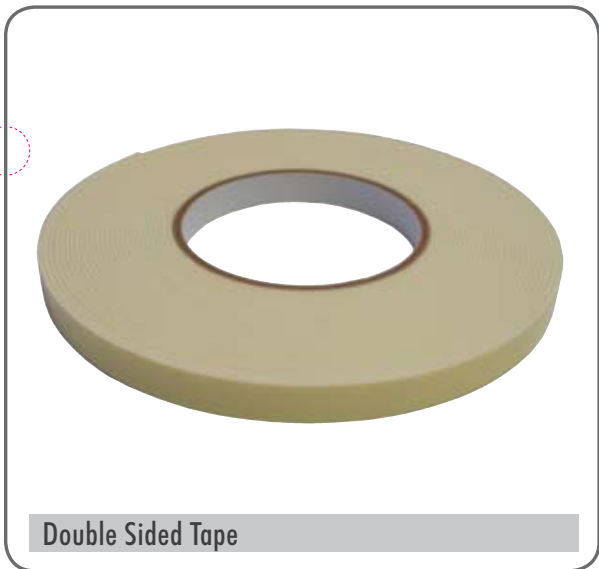

Double Sided Tape

Features			
• Multipurpose double sided tape			
• Thicker double sided adhesive for greater adhesion to irregular surfaces			
• Excellent for general purpose mounting and joining applications			
Specifications			
Part No.	Thickness (mm)	Width (mm)	Length (m)
WATDST12	1.7	12	10
WATDST18	1.7	18	10
WATDST24	1.7	24	10



PVC Electrical Insulating Tape

Features				
• For superior insulation of electrical cables				
• Self adhesive tape				
• For bundling cables and lines				
• High flexibility				
• Safe and easy to use				
• Temperature range of -10 °C to +80 °C				
• Rainbow pack comes in pack of 10				
Specifications				
Part No.	Colour	Thickness (mm)	Width (mm)	Length (m)
WATPVCGYLT	Green/Yellow	0.18	18	20
WATPVCOLT	Orange	0.18	18	20
WATPVCRLT	Red	0.18	18	20
WATPVCWLT	White	0.18	18	20
WATPVCGLT	Grey	0.18	18	20
WATPVCBLULT	Blue	0.18	18	20
WATPVCBLALT	Black	0.18	18	20
WATPVCBRLT	Brown	0.18	18	20
WATPVCRP	Rainbow Pack	0.15	18	20



PVC Duct Tape

Features				
• PVC sealing and joining duct tape				
• Coated with pressure-sensitive adhesive				
• Grey in colour				
• Moisture, corrosion & weather resistant tape				
• Provides excellent protection				
• PVC tape suitable for joining flexible duct				
Specifications				
Part No.	Description	Thickness (mm)	Width (mm)	Length (m)
WATPVCDT	Duct Tape	0.13	48	30



Pressure Tape

Features				
• For sealing cast resin joints				
• Transparent in colour				
Specifications				
Part No.	Type	Thickness (mm)	Width (mm)	Length (m)
ALC125PT711	No. 71	0.15	25	33
ALC125PT712	No. 71	0.15	38	33
Technical Data		Value		
Tensile strength		12 N/mm ²		
Elongation at break		400%		
Temperature resistance		+ 100 °C		
Dielectric strength		78 kV/mm		
Volume resistivity		10 ¹³ Ω x cm		



Repair Tape

Features				
• Self-amalgamating				
• For repairing damaged sheaths of plastic and rubber insulated cables and connectors				
• Very good electrical properties				
• Excellent tensile strength				
• 100% Waterproof				
• Black in colour				
Specifications				
Part No.	Type	Thickness (mm)	Width (mm)	Length (m)
ALC125RT72	No. 72	0.75	25	10
Technical Data		Value	Test Method	
Tensile strength		2 N/mm ²	ASTM D 412	
Elongation at break		600%	ASTM D 412	
Temperature resistance		+ 90 °C	-	
Dielectric strength		40 kV/mm	ASTM D 149	
Volume resistivity		10 ¹⁵ Ω x cm	ASTM D 257	
Water absorption (24 h)		0.4%	ASTM D 570	
Dielectric constant (50 Hz)		2.5 A x s/V x m	ASTM D 150	
Loss factor (50 Hz)		0.0014	ASTM D 150	



Sealing Tape

Features				
• Excellent adhesion to metal, glass and plastic				
• Good dielectrical and physical properties				
• Self-amalgamating				
• Permanently elastic				
• Suitable for connections with acrylic and epoxy resin compound				
• For sealing and repairing cables				
• Provides weatherproof sealing and protection against dust, humidity and corrosion				
• Black in colour				
Specifications				
Part No.	Type	Thickness (mm)	Width (mm)	Length (m)
ALC125ST64	No. 64	3.20	38	1.52
Technical Data		Value		
Water absorption		0.1%		
Dielectric strength		16 kV/mm		
Dielectric constant (50 Hz)		3.1 A x s/V x m		
Power factor (50 Hz)		0.025		
Volume resistivity (20 °C)		2 x 10 ¹⁰ Ω x m		
Temperature range		-30 °C to +80 °C		
Elongation at break		> 1000%		
Tensile strength		0.12 N/mm		



Underground Marking Tape

Features			
• Bright non-adhesive PVC underground identification tape			
• Acts as warning for dangerous situations			
• Eye catching large letters printed on non-adhesive tape			
• Great for trench identification			
• Orange reflective tape for vibrant daytime visibility			
• Printed 'CAUTION - ELECTRICAL CABLE BELOW' (orange) without wire tracer			
• Printed 'CAUTION - BURIED COMMUNICATIONS BELOW' (white) with wire tracer			
Specifications			
Part No.	Colour	Width (mm)	Length (m)
WATPVCUMT	Orange	150	500
WATUMTW250	White	150	250
WATUMT100	Orange	150	100



Caution Tape



Copper Braid Tape

Features				
• Woven tinned copper wires				
• Extremely flexible				
• Strong				
• Fits all contours without folds				
• Ideal for shielding and protecting cables				
• Silver in colour				
Specifications				
Part No.	Type	Thickness (mm)	Width (mm)	Length (m)
ALC126CBT631	No. 63	0.5	25	5
ALC126CBT633	No. 63	0.5	60	5
Features				
• Bright yellow reflective tape for vibrant daytime visibility				
• Suitable for outdoor use				
• Tape has aggressive adhesive that sticks to any clean, dry surface				
• Printed 'CAUTION - Temporary Construction Wiring'				
Specifications				
Part No.	Colour	Width (mm)	Length (m)	
WATCTAPE	Yellow	38	50	

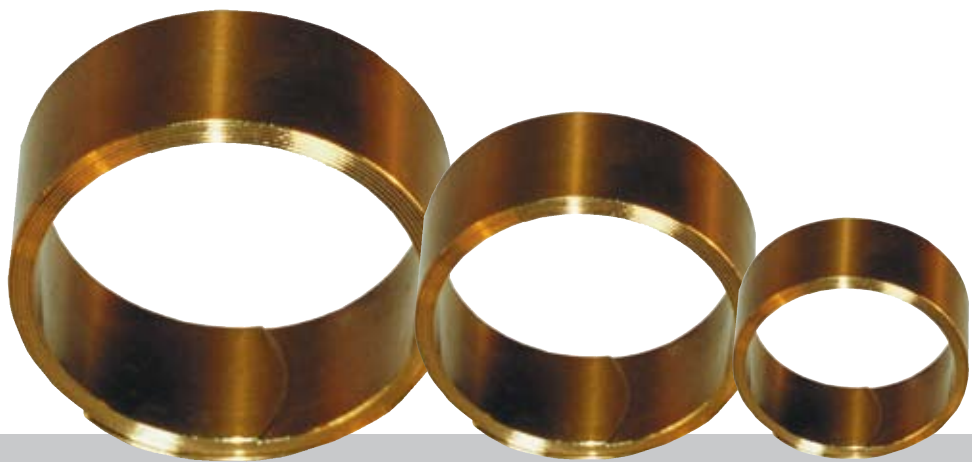

Pressure Spring

Part No	Type	For Cable (mm)	External Diameter (mm)	Width (mm)
ALC126PS0	RF 0	6-10	5.7	16
ALC126PS0.5	RF 0.5	9-14	8.5	16
ALC126PS1	RF 1	13-22	13.0	16
ALC126PS2	RF 2	17-28	17.5	16
ALC126PS3	RF 3	24-37	21.5	16
ALC126PS4	RF 4	33-49	29.0	16
ALC126PS5	RF 5	44-70	37.8	20
ALC126PS6	RF 6	55-92	51.3	20

Features - Pressure Spring

- For a solder free electric connection between metal cable elements and earthing devices
- Used for cast resin, heatshrink and medium voltage joints
- Corrosion free
- Excellent mechanical stability
- Assures constant radial pressure
- Made from special stainless steel metal
- Copper in colour
- Pressure springs are non-current carrying parts

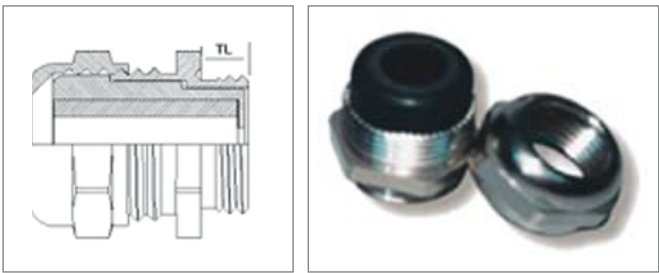

These cable glands are constructed with a double seal, which provides a wide range of clamping. For high temperature resistance the gland can be produced with special silicone sealing.

- Body and Cap: Brass Nickel Plated
- Sealing: Neoprene
- Clamping: Polyamide 6
- O Ring: NBR
- Protection Class: IP 68

Part No.	Thread Diameter (mm)	Cable OD (mm)	Thread Length (mm)	Diameter Across Flats (mm)
ALCHTG12	M12 x 1.5	4.0-6.0	5	14
ALCHTG16	M16 x 1.5	4.0-9.0	5	18
ALCHTG20	M20 x 1.5	7.0-13.0	6	22
ALCHTG25	M25 x 1.5	10.0-18.0	7	28
ALCHTG32	M32 x 1.5	16.0-24.0	8	35
ALCHTG40	M40 x 1.5	22.0-32.0	8	45



Cleaner/Degreaser

Features

- Contains two individually sealed towelettes (ALCHP-P158ID)
- One wipe is lightly saturated, while the other wipe is dry (ALCHP-P158ID)
- Convenient and no need for rags (ALCHP-P158ID)
- No wasted solvent
- Quick and easy to use
- Low level of toxicity
- Does not form vapours quickly
- Suitable for cleaning and degreasing
- One cleaner for all electrical cleaning needs
- For general industrial and maintenance needs

Specifications

Part No	Description
ALCHP-P158ID	Multipurpose Cleaner/Degreaser
ALCHP-35LR	Trigger Sprayer Cleaner/Degreaser Size: 0.95 Litres

Technical Data	Value	Test Method
Dielectric Strength	>40KV	
Relative Evaporation Rate	Medium	
Residue	>100 ppm	ASTM D 2369
Flashpoint	>60.5°C	ASTM D 56
Initial Boiling Point	185°C	
Specific Gravity	0.79	
Percent Aromatics	<1%	
Propellant (aerosol only)	CO ₂	
Cleaning strength	Excellent	
KB value	33	
Water content	<50 ppm	ASTM D 153313



Solvent Wipe

Features

- Pre-saturated solvent wipes sealed in foil pouch
- Non-conductive and compatible with most materials
- Fast evaporating and non-flammable cleaner
- Excellent solvency properties
- Ideal for field use

Specifications

Part No	Size
ALCTR-1	5" x 8"



Sanding Cloth

Features

- Sanding cloth for cable cleaning
- Non-conductive aluminium oxide sanding cloth
- Resists shredding
- Eliminates waste
- Easy to use

Specifications

Part No	Width (mm)	Length (m)
ALCSPROLL	25	45

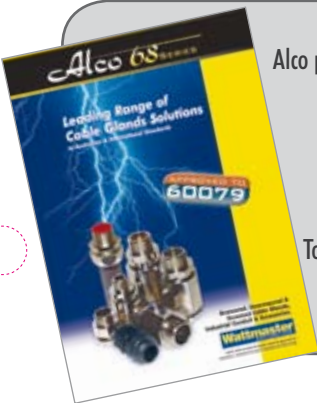

Alco provides a comprehensive range of armoured, unarmoured and screened cable glands for indoor and outdoor applications that are designed in Australia to meet Australian and international standards.

We also offer a full range of Anaconda metal conduit and fittings, and cable gland solutions ranging from accessories such as shrouds, locknuts and earth tags.

To view our full range, please see our Alco Cable Glands & Cable Accessories Catalogue.

Simply call our service centre on 1300 300 747 for your FREE copy now!

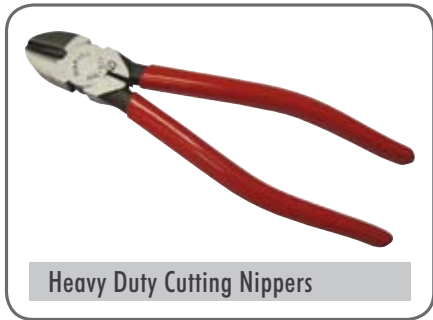

Heavy Duty Cutting Nippers

- Features
- Tough nippers with bevelled blades
 - Recarbonised for extra surface hardness to handle hardened steel wires
 - Drop forged vanadium steel, heat treated
 - Bevelled edge cutter
 - Cuts steel and copper wire
 - Ground head
 - Dipped vinyl grips
 - Black finish with polished jaws
- Specifications

Part No.	Length (mm)	Weight (g)
WATMA620	175	200



High Leverage Cutting Nippers

- Features
- High leverage design with bevelled blades
 - For heavy duty cutting of steel wires
 - Drop forged nickel chrome steel
 - Black finish with polished jaws
 - Dipped vinyl grips
- Specifications

Part No.	Length (mm)	Weight (g)
WATMA730	200	340



Cable Cutter

- Features
- Blades and handles are one piece drop forged carbon steel
 - Polished head with dipped vinyl grips
 - Cuts copper cable
- Specifications

Part No.	Length (mm)	Weight (g)
WATUPWB	200	320



Industrial Cable Cutter

- Features
- Suitable for cutting steel wire rope, low carbon steel and aluminium cable
 - Made from high carbon steel
 - Cuts up to 400mm² stainless steel and aluminium cable
 - Cuts up to 12mm diameter steel wire rope
- Specifications

Part No.	Weight (kg)	Size (mm)
WATCCJ13	1.8	340 (500) x 130 x 40



Industrial Cable Cutter

- Features
- This cable cutter is used to cut steel wire rope
 - Made from high carbon steel
 - Cuts up to 20mm diameter steel wire rope
- Specifications

Part No.	Weight (kg)	Size (mm)
WATCCJ14	1.8	340 (500) x 130 x 40



Cable Cutter

- Features
- Lightweight
 - Blades and handles are one piece drop forged steel
 - Blade shape is designed to cut without distortion
 - Polished head with dipped vinyl grips
 - Cushioned grips
- Specifications

Part No.	Length (mm)	Weight (g)	Max copper cable area
WATME22C	160	185	22 mm ²



Cable Cutter

- Features
- Lightweight
 - Blades and handles are one piece drop forged steel
 - Blade shape is designed to cut without distortion
 - Polished head with dipped vinyl grips
 - Handy pocket or pouch cutter for one handed use
 - Black finish with polished jaws
- Specifications

Part No.	Length (mm)	Weight (g)	Max copper cable area
WATME38	210	260	38 mm ²



Cable Cutter

- Features
- Lightweight
 - Blades and handles are one piece drop forged carbon steel
 - Blade shape is designed to cut without distortion
 - Precise pivot adjustment for smooth handle action
 - Polished head with dipped vinyl handles for better grip
- Specifications

Part No.	Length (mm)	Weight (g)	Max copper cable area
WATME60	235	430	60 mm ²



Industrial Cable Cutter

- Features
- Do not cut steel wire
 - Made from high carbon steel
 - Cuts up to 300mm² copper aluminium armoured steel
 - Cuts up to 1000 pairs of communication cable
 - Max aluminium cable size is limited by the size of the blades
- Specifications

Part No.	Weight (kg)	Size (mm)
WATCCJ40	1.1	325 x 120 x 35



Industrial Cable Cutter

- Features
- Cutter not suitable for cutting steel wire
 - Max aluminium cable size is limited by the size of the blades
 - Blades can be resharpened and replaced
 - Cutter can be used in water and can be washed after use
 - Cuts 3 x 120mm² armoured cable
- Specifications

Part No.	Weight (kg)	Size (mm)
WATCCJ76	3.7	400 (600) x 205 x 50



Ratchet Cable Cutter

Features

- Ratchet controlled with release option
- One hand operation
- Locking lever
- Cuts copper and aluminium cable with blur free cut
- Made from high strength special steel
- Ergonomically shaped handles with non-slip grip

Specifications

Part No.	Weight (g)	Max Cable Diameter	
		Standard (mm)	Solid (mm)
WATSH320	250	32	25/15 (CU/AL)
WATSH500	500	52	25/15 (CU/AL)



Universal Crimping Tool

Features

- Crimping tool can be used with most common terminals and connectors
- Made from hardened 3mm special alloy steel
- Ratchet mechanism
- Hardened die sets
- Dies not in use can be stored in handles
- 3-in-1 crimping tool crimps pre-insulated, non-insulated and bootlace terminals
- Crimping dies can be changed within seconds by simple 'click' action, no screws required

Specifications

Part No.	Length (mm)	Weight (g)
WATK007	240	780
Crimping Size (mm²)		
Pre-insulated terminals	0.5-1.5, 1.5-2.5, 2.5-6.0	
Non-insulated terminals	0.5-10.0	
Bootlace terminals	0.5-10.0	



Ratchet Crimping Tool

Features

- For crimping non-insulated copper terminals
- Light and easy to operate
- Complete crimp with one hand
- Jaws made of chrome molybdenum steel
- Long lasting precision tool
- Nickel chrome plated handles with non-slip vinyl grips
- Black finished jaws

Specifications

Part No.	Length (mm)	Weight (g)	Crimper Terminal Size (mm²)
WATMH88	280	500	2.5, 6.0, 10.0, 16.0
WATMH61S	260	430	1.5, 2.5, 6.0, 10.0



Wire Stripper

Features

- Strips small diameter cables in a single movement
- Precision ground special tool steel blades cut cleanly through insulation & avoid damage to conductors
- Gentle action to handle fine cables
- Diecast alloy body with vinyl grips
- Locking action prevents the jaws snapping back onto stripped cables
- Adjustable stops allows consistent stripping length

Specifications

Part No.	Length (mm)	Weight (g)	Cable Sizes (mm²)
WATMES202	170	365	0.5-0.75, 1.0, 1.5, 2.5, 4.0, 6.0
WATMES301	170	365	22, 20, 18, 16-4, 12, 10 AWG



Swivel Blade Cable Strippers

Features

- Adjustable cutting depth for various circular cables to help prevent any change to conductors
- Light weight and supplied with additional spare blade
- Strips rubber, PVC, teflon and polyethylene
- Centre or end stripping
- Made from high grade wear-resistant polyamide

Specifications

Part No.	Conductor Stripping Diameter	Length (mm)	Weight (g)
WAT10160	4 - 16 mm	122	75
WAT10270	8 - 28 mm	122	75
WAT10280	8 - 28 mm	165	85
WAT10350	27 - 37 mm	150	106
WAT10500	35 - 50 mm	170	117



Combination Crimping Pliers

Features

- Heavy duty combination crimping pliers
- Nickel chrome plated with non-slip vinyl grips
- Dies cast from chrome molybdenum steel and heat treated
- Combination wire stripper / crimper for pre-insulated terminals
- Terminal crimping size - 6.0, 10.0, 16.0, 25.0 mm²

Specifications

Part No.	Length (mm)	Weight (g)
WATKS2045E	350	800



Hand Operated Mechanical Crimper

Features

- Hand operated mechanical crimping tool for copper lugs and links
- Built-in crimp die set to range of different sizes
- No dies to replace; simply rotate die to required crimp size
- Bonus 120mm² cable cutter included
- Crimping range: 6-120mm²
- Crimping Type: Hexagonal

Specifications

Part No.	Length (mm)	Weight (g)
WATMECH6120P	600	3920



Power Blade Cable Cutter

Features

- Versatile, fits any drill that accepts 3/8" drive shaft
- Sturdy blades ensure consistent cuts and durability
- Cable distortion is minimized due to blade design
- Non-slip handle for ease and comfort
- Easy to use
- Cuts up to 40mm overall cable diameter

Specifications

Part No - WATPBCC35-078



Electrician's Knife

Features

- Single folding blade knife
- Hollow ground, heavy duty blade
- Heat treated carbon steel blade
- Blade protected by non-conducting hardwood handle
- Blade hand honed for sharpness
- Convenient folding blade
- Heavy duty blade made of special high carbon steel

Specifications

Part No.	Blade length (mm)	Length (mm)	Weight (g)
WATMEK70J	70	120	140



Semi Automatic Utility Knife

Features

- Auto - loading with comfort grip
- Includes 10 spare blades
- Heavy duty zinc alloy body
- Retractable blade
- 3 blade positions

Specifications

Part No.	Blade length (mm)	Length (mm)	Weight (g)
WATUKSA	19	175	300

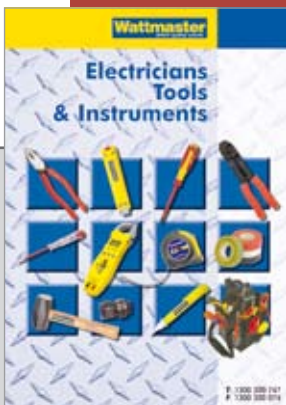

Wattmaster provides an extensive range of Electrician's Tools, Instruments & Consumables with the tradesperson in mind.

Encompassing products from cable cutting tools through to safety products, our product range exceeds our very stringent quality control criteria.

Information on the following brands is detailed in our Wattmaster Catalogue.

Please call our service centre on 1300 300 747 for your FREE copy now!

- Marvel Hand Tools
- Rola-case Storage Systems
- Witte Screwdrivers & Accessories
- Alco Cable Glands

C

Cable Cutters.....	28
Cable Repair Kit.....	22
Cast Resin Branch Cable Joint.....	16
Cast Resin Overview.....	14
Cast Resin Straight Through Cable Joint.....	15
Cast Resin - Type EG.....	17
Cast Resin - Type KG.....	18
Cast Resin - Type M Joint.....	15
Cast Resin - Type MZ Joint.....	15
Cast Resin - Type Y Joint.....	16
Caution Tape.....	25
Cleaners/Degreasers.....	27
Conducting Tape.....	22
Copper Braid Tape.....	25
Copper Links.....	13
Copper Lugs.....	12
Crimpers.....	30
Cutting Nippers.....	28

D

Degreasers/Cleaners.....	27
Double Sided Tape.....	23
Duct Tape.....	23

E

Electrical Tape.....	23
----------------------	----

H

Hand Tools.....	28-31
Heat Gun Kit.....	9
Heatshrink - Thin.....	6
Heatshrink - Medium.....	6
Heatshrink - Thick.....	6
Heatshrink Joint.....	4
Heatshrink Kits.....	8
Heatshrink/Lugs & Links Selection Chart.....	12
Heatshrink Repair Sleeve.....	11
Heatshrink Straight Through Joint.....	10
Heatshrink Technical Data.....	8
High Temperature Glands.....	26
High Voltage Insulation Tape.....	22

I

Industrial Cable Cutters.....	29
Insulation Tapes.....	22
Insulputty.....	19

J

Junction boxes.....	20
---------------------	----

K

Knives.....	31
-------------	----

L

Links.....	13
Lugs.....	12
Lugs & Links Kit.....	9

P

Performing Heatshrink Joint.....	4
Pre-insulated Terminals, Lugs & Links Mixed Kit.....	9
Pressure Springs.....	26
Pressure Tape.....	24
PVC Insulation Tape.....	23
PVC Underground Marking Tape.....	25

Q

Quick boxes.....	19
------------------	----

R

Ratchet Crimpers.....	30
Repair Sleeve.....	11
Repair Tape.....	24
Resin.....	14-18

S

Sanding Cloth.....	27
Sealing Kits Selection Chart.....	21
Sealing Mastic Tape.....	22
Sealing Tape.....	24
Side Cutters.....	28
Solvent Wipes.....	27
Specialty Kit.....	22
Specialty Tapes.....	22

T

Tapes.....	22-25
Terminals, Lugs & Links Mixed Kit.....	9
Tools.....	28-31

U

Underground Marking Tape.....	25
Universal Cable Repair Kit.....	22

W

Weatherproof Quickboxes.....	19
Wire Strippers.....	31

Index - by part number

ALC124EG1000	17	ALCHSKIT1	8	ALCL150M16/10	13	ALCLK16/25	13	ALCQJR161	21	HSJP4X120-150	10	HSTNW100/50RD	6	HSTNW200/75WH	7	WAT10160	31
ALC124EG1150	17	ALCHSKIT2	8	ALCL16M10/25	12	ALCLK185/6	13	ALCQJR162	21	HSJP4X16-25	10	HSTNW100/50WH	6	HSTNW200/75Y	7	WAT10270	31
ALC124EG143	17	ALCHTG12	26	ALCL16M12/25	12	ALCLK2.5/100	13	ALCQJR163	21	HSJP4X185-240	10	HSTNW100/50Y	6	HSTNW200/75YG	7	WAT10280	31
ALC124EG1500	17	ALCHTG16	26	ALCL16M6/25	12	ALCLK240/6	13	ALCQJR164	21	HSJP4X35-50	10	HSTNW100/50YG	6	HSTNW22/11BK	7	WAT10350	31
ALC124EG2000	17	ALCHTG20	26	ALCL16M8/25	12	ALCLK25/25	13	ALCQJR201	21	HSJP4X70-95	10	HSTNW120/60BK	6	HSTNW22/11BL	7	WAT10500	31
ALC124EG286	17	ALCHTG25	26	ALCL185M10/6	13	ALCLK300/3	13	ALCQJR201D	21	HSJP5X06-10	10	HSTNW120/60BL	6	HSTNW22/11CL	7	WATCCJ13	29
ALC124EG370	17	ALCHTG32	26	ALCL185M12/6	13	ALCLK35/25	13	ALCQJR202	21	HSJP5X1.5-4	10	HSTNW120/60CL	6	HSTNW22/11G	7	WATCCJ14	29
ALC124EG464	17	ALCHTG40	26	ALCL185M16/6	13	ALCLK4/100	13	ALCQJR202A	21	HSJP5X16-25	10	HSTNW120/60RD	6	HSTNW22/11RD	7	WATCCJ40	29
ALC124EG730	17	ALCIP38	19	ALCL2.5M4/100	12	ALCLK400/3	13	ALCQJR202D	21	HSMWGL10/3	6	HSTNW120/60WH	6	HSTNW22/11WH	7	WATCCJ76	29
ALC124EG80	17	ALCJB161	20	ALCL2.5M5/100	12	ALCLK50/25	13	ALCQJR202DA	21	HSMWGL115/34	6	HSTNW120/60Y	6	HSTNW22/11Y	7	WATCTAPE	25
ALC124M11	15	ALCJB162	20	ALCL2.5M6/100	12	ALCLK500/3	13	ALCQJR203	21	HSMWGL140/42	6	HSTNW120/60YG	6	HSTNW22/11YG	7	WATDST12	23
ALC124M12	15	ALCJB163	20	ALCL2.5M8/100	12	ALCLK6/50	13	ALCQJR203D	21	HSMWGL16/5	6	HSTNW13.0/6.5BK	6	HSTNW40/20BK	7	WATDST18	23
ALC124M13	15	ALCJB164	20	ALCL240M12/6	13	ALCLK630/3	13	ALCQJR204	21	HSMWGL25/8	6	HSTNW13.0/6.5BL	6	HSTNW40/20BL	7	WATDST24	23
ALC124M14	15	ALCJB201	20	ALCL240M16/6	13	ALCLK70/10	13	ALCQJR204D	21	HSMWGL35/12	6	HSTNW13.0/6.5CL	6	HSTNW40/20CL	7	WATHGK	9
ALC124M15	15	ALCJB201D	20	ALCL240M20/6	13	ALCLK95/10	13	ALCQJR251	21	HSMWGL50/16	6	HSTNW13.0/6.5RD	7	HSTNW40/20G	7	WATIP180	19
ALC124M16	15	ALCJB202	20	ALCL240M8/6	13	ALCLLKIT10	9	ALCQJR251D	21	HSMWGL85/25	6	HSTNW13.0/6.5WH	7	HSTNW40/20RD	7	WATK007	30
ALC124MZ0	15	ALCJB202A	20	ALCL240MB/6	13	ALCPTLLKIT18	9	ALCQJR252	21	HSRS115-30	11	HSTNW13.0/6.5Y	7	HSTNW40/20WH	7	WATKS2045E	30
ALC124MZ00	15	ALCJB202D	20	ALCL25M10/25	12	ALCQJN161	21	ALCQJR252A	21	HSRS125-32	11	HSTNW13.0/6.5YG	7	HSTNW40/20Y	7	WATMA620	28
ALC124Y1	16	ALCJB202DA	20	ALCL25M12/25	12	ALCQJN162	21	ALCQJR252D	21	HSRS150-50	11	HSTNW150/70BK	7	HSTNW40/20YG	7	WATMA730	28
ALC124Y4	16	ALCJB203	20	ALCL25M6/25	12	ALCQJN163	21	ALCQJR252DA	21	HSRS28-10	11	HSTNW150/70BL	7	HSTNW5.0/2.5BK	7	WATME22C	28
ALC125CONT61	22	ALCJB203D	20	ALCL25M8/25	12	ALCQJN164	21	ALCQJR253	21	HSRS43-12	11	HSTNW150/70CL	7	HSTNW5.0/2.5BL	7	WATME38	28
ALC125HVT60	22	ALCJB204	20	ALCL300MB/3	13	ALCQJN201	21	ALCQJR253D	21	HSRS72-18	11	HSTNW150/70RD	7	HSTNW5.0/2.5CL	7	WATME60	28
ALC125KG143	18	ALCJB204D	20	ALCL35M10/25	12	ALCQJN201D	21	ALCQJR254	21	HSRS93-26	11	HSTNW150/70WH	7	HSTNW5.0/2.5G	7	WATMECH6120P	30
ALC125KG286	18	ALCJB251	20	ALCL35M12/25	12	ALCQJN202	21	ALCQJR254D	21	HSTKWGL13/4	6	HSTNW150/70Y	7	HSTNW5.0/2.5RD	7	WATMEK70J	31
ALC125KG730	18	ALCJB251D	20	ALCL35M6/25	12	ALCQJN202A	21	ALCQJR321	21	HSTKWGL130/36	6	HSTNW150/70YG	7	HSTNW5.0/2.5WH	7	WATMES202	31
ALC125PT711	24	ALCJB252	20	ALCL35M8/25	12	ALCQJN202D	21	ALCQJR322	21	HSTKWGL19/6	6	HSTNW18/9BK	7	HSTNW5.0/2.5Y	7	WATMES301	31
ALC125PT712	24	ALCJB252A	20	ALCL35MB/25	12	ALCQJN202DA	21	ALCQJR323	21	HSTKWGL28/9	6	HSTNW18/9BL	7	HSTNW5.0/2.5YG	7	WATMH61S	30
ALC125RT72	24	ALCJB252D	20	ALCL400MB/3	13	ALCQJN203	21	ALCQJR324	21	HSTKWGL38/12	6	HSTNW18/9CL	7	HSTNW50/25BK	7	WATMH88	30
ALC125ST64	24	ALCJB252DA	20	ALCL4M5/100	12	ALCQJN203D	21	ALCQJRER25	21	HSTKWGL51/16	6	HSTNW18/9G	7	HSTNW50/25BL	7	WATPBC35-078	30
ALC126CBT631	25	ALCJB253	20	ALCL4M6/100	12	ALCQJN204	21	ALCQJRQB0	21	HSTKWGL68/22	6	HSTNW18/9RD	7	HSTNW50/25CL	7	WATPVCBLALT	23
ALC126CBT633	25	ALCJB253D	20	ALCL4M8/100	12	ALCQJN204D	21	ALCQJRQB1	21	HSTKWGL90/30	6	HSTNW18/9WH	7	HSTNW50/25G	7	WATPVCBLULT	23
ALC126PS0	26	ALCJB254	20	ALCL500MB/3	13	ALCQJN251	21	ALCQJRQB2	21	HSTNW1.5/0.75BK	6	HSTNW18/9Y	7	HSTNW50/25RD	7	WATPVCBRLT	23
ALC126PS0.5	26	ALCJB254D	20	ALCL50M10/10	12	ALCQJN251D	21	ALCQJRQB3	21	HSTNW1.5/0.75BL	6	HSTNW18/9YG	7	HSTNW50/25WH	7	WATPVCDT	23
ALC126PS1	26	ALCJB321	20	ALCL50M12/10	12	ALCQJN252	21	ALCQJRQB4	21	HSTNW1.5/0.75CL	6	HSTNW2.0/1.0BK	7	HSTNW50/25Y	7	WATPVCGLT	23
ALC126PS2	26	ALCJB322	20	ALCL50M8/10	12	ALCQJN252A	21	ALCRESKIT1	22	HSTNW1.5/0.75G	6	HSTNW2.0/1.0CL	7	HSTNW50/25YG	7	WATPVCGYL	23
ALC126PS3	26	ALCJB323	20	ALCL630MB/3	13	ALCQJN252D	21	ALCSPROLL	27	HSTNW1.5/0.75RD	6	HSTNW2.0/1.0RD	7	HSTNW7.0/3.55BK	7	WATPVCOLT	23
ALC126PS4	26	ALCJB324	20	ALCL6M10/50	12	ALCQJN252DA	21	ALCTR-1	27	HSTNW1.5/0.75WH	6	HSTNW2.0/1.0WH	7	HSTNW7.0/3.55BL	7	WATPVCRLT	23
ALC126PS5	26	ALCJBDL	20	ALCL6M6/50	12	ALCQJN253	21	ALCWQB-0	19	HSTNW1.5/0.75Y	6	HSTNW2.0/1.0Y	7	HSTNW7.0/3.55CL	7	WATPVCRP	23
ALC126PS6	26	ALCJBER25	20	ALCL6M8/50	12	ALCQJN253D	21	ALCWQB-1	19	HSTNW1.5/0.75YG	6	HSTNW2.0/1.0YG	7	HSTNW7.0/3.55G	7	WATPVCUMT	25
ALC127SMT	22	ALCL1.5M4/100	12	ALCL70M10/10	12	ALCQJN254	21	ALCWQB-2	19	HSTNW10.0/5.0BK	6	HSTNW2.5/1.25BK	7	HSTNW7.0/3.55RD	7	WATPVCWLT	23
ALC131Y3	16	ALCL1.5M5/100	12	ALCL70M12/10	12	ALCQJN254D	21	ALCWQB-3	19	HSTNW10.0/5.0BL	6	HSTNW2.5/1.25BL	7	HSTNW7.0/3.55WH	7	WATSH320	30
ALC131Y3.5	16	ALCL1.5M6/100	12	ALCL70M16/10	12	ALCQJN321	21	ALCWQB-4	19	HSTNW10.0/5.0CL	6	HSTNW2.5/1.25CL	7	HSTNW7.0/3.55Y	7	WATSH500	30
ALC131Y4.5	16	ALCL10M10/25	12	ALCL70M8/10	12	ALCQJN322	21	HSJC4X06-10	10	HSTNW10.0/5.0G	6	HSTNW2.5/1.25G	7	HSTNW7.0/3.55YG	7	WATUGMTW250	25
ALC131Y6	16	ALCL10M12/25	12	ALCL95M10/10	12	ALCQJN323	21	HSJC4X1.5-4	10	HSTNW10.0/5.0RD	6	HSTNW2.5/1.25RD	7	HSTNW70/35BK	7	WATUKSA	31
ALC133Y00	16	ALCL10M6/25	12	ALCL95M12/10	12	ALCQJN324	21	HSJC4X120-150	10	HSTNW10.0/5.0WH	6	HSTNW2.5/1.25WH	7	HSTNW70/35BL	7	WATUMT100	25
ALC145HVT62	22	ALCL10M8/25	12	ALCL95M16/10	12	ALCQJNER25	21	HSJC4X16-25	10	HSTNW10.0/5.0Y	6	HSTNW2.5/1.25YG	7	HSTNW70/35CL	7	WATUPWB	28
ALC147Y2	16	ALCL120M10/10	13	ALCL95M8/10	12	ALCQJNQB0	21	HSJC4X185-240	10	HSTNW10.0/5.0YG	6	HSTNW2.5/1.55Y	7	HSTNW70/35G	7		
ALC152Y0	16	ALCL120M12/10	13	ALCLK1.5/100	13	ALCQJNQB1	21	HSJC4X35-50	10	HSTNW100/50BK	6	HSTNW200/75BK	7	HSTNW70/35RD	7		
ALC157Y5	16	ALCL120M16/10	13	ALCLK10/50	13	ALCQJNQB2	21	HSJC4X70-95	10	HSTNW100/50BL	6	HSTNW200/75BL	7	HSTNW70/35WH	7		
ALCHP-35LR	27	ALCL150M10/10	13	ALCLK120/10	13	ALCQJNQB3	21	HSJP4X06-10	10	HSTNW100/50CL	6	HSTNW200/75CL	7	HSTNW70/35Y	7		
ALCHP-P158ID	27	ALCL150M12/10	13	ALCLK150/6	13	ALCQJNQB4	21	HSJP4X1.5-4	10	HSTNW100/50G	6	HSTNW200/75RD	7	HSTNW70/35YG	7		



**54 Lakewood Boulevard
Carrum Downs
Victoria 3201 Australia**

Head Office:
Tel: 03 9775 1186 Fax: 03 9775 1187
Email: sales@elmako.com.au

Service Centres:
Australia
Tel: 1300 300 747 Fax: 1300 300 074

**Electrical Products
Across Australia**

Adelaide
Brisbane
Darwin
Hobart
Melbourne
Perth
Sydney
Townsville

Available from

Whilst every precaution is taken to ensure the information contained herein is correct, Wattmaster accepts no liability whatsoever for errors or omissions. In the interest of continuous improvement, Wattmaster reserves the right to change the specifications or design of any of its products without prior notice. © Copyright 2006